



28°34'52.10"N 77°15'36.67"E

NOTE:
 NOT PART OF THE SCOPE OF WORK:
 - SIDDHARTHA EXTENSION POCKET - A
 - SIDDHARTHA EXTENSION POCKET - C

- RESIDENTIAL
- COMMERCIAL
- PUBLIC SEMI-PUBLIC
- GREEN AREA
- VILLAGE

- LEGEND**
- TREE
 - STREET LIGHTS
 - BUILDING
 - COLONY GATE KEPT OPEN
 - COLONY GATE KEPT CLOSED
 - SPEED BREAKER

**PARKING AREA MANAGEMENT PLAN
 SIDDHARTHA EXTN.
 POCKET - B
 LANDUSE**

ALL DIMENSIONS IN: SHEET **1/5**
 N.A.
 SCALE: 1 : 500 (SHEET A1)

SOUTH ZONE:		
SUPERINTENDING ENGINEER	EXECUTIVE ENGINEER	
ASSISTANT ENGINEER	JUNIOR ENGINEER	
R.P. CELL:		
TRANSPORT CONSULTANT	A.C. RP CELL	
A.O. RP CELL	AREA INSPECTOR	JR. ENGINEER
DATE: 3rd January 2021		



TRANSPORT AUTHORITY SARAI KALE KHAN

PARKING PLANNED AS PER FEASIBILITY ON THE GROUND.
 THE NAME OF SHOPS, BUILDINGS AND LANDMARKS MAY / MAY NOT CHANGE WITH THE PASSAGE OF TIME.

1. DUMPED VEHICLES IN THE COLONY NOT ONLY LOOK UNPLEASANT BUT ALSO BLOCK THE SPACE THAT CAN BE UTILISED BY THE RESIDENTS FOR RUNNING VEHICLES.



2. RESIDENTS BLOCK THE PUBLIC SPACES WITH OLD 2-WHEELERS, POTS ETC. AND CLAIM THEM TO BE RESERVED FOR THEIR PRIVATE VEHICLES.



THERE ARE FREQUENT QUARRELS AMONG THE RESIDENTS OVER THE ISSUE OF PARKING

3. A BUILDING ERRECTED IN AN OFF-STREET PARKING LOT HAS COVERED A LOT OF AREA. REMOVING THIS WILL CREATE MORE SPACE FOR PARKING.



ACTIVITIES UNDERTAKEN HERE CAN BE DONE IN THE COMMUNITY CENTER.

4. ANOTHER SMALL BUILDING LOCATED NEAR GATE NO. 2 CREATES THE BOTTLE-NECK. DEMOLISHING IT WILL MAKE THE ENTRY & EXIT OF THE VEHICLES SMOOTH.



GUARD ROOM ALREADY EXISTS NEXT TO THE GATE.

5. SOME RESIDENTS PARK THEIR VEHICLES IN FRONT OF THE CLOSED GATE NO. 3. THIS GATE SHOULD BE OPEN ALL THE TIME FOR EASY MOVEMENT.



6. THERE STANDS AN UNUSED STRUCTURE ERRECTED BY POCKET-C RESIDENTS IN POCKET-B. DEMOLISHING IT WILL CREATE MORE SPACE FOR PARKING.



7. SHOP OWNERS PARK THEIR 2-WHEELERS INSIDE THE SHOPPING AREA WHICH IS MEANT FOR THE PEDESTRIANS. BOLLARDS ARE TO BE PUT AT CERTAIN LOCATIONS.



8. DEMOLISHING THE RAISED PLATFORM WILL MAKE MORE SPACE FOR PARKING. THE PLATFORM SERVES NO PURPOSE.

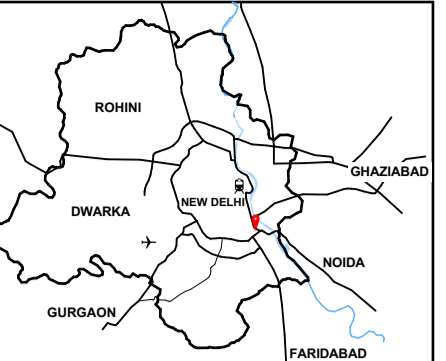
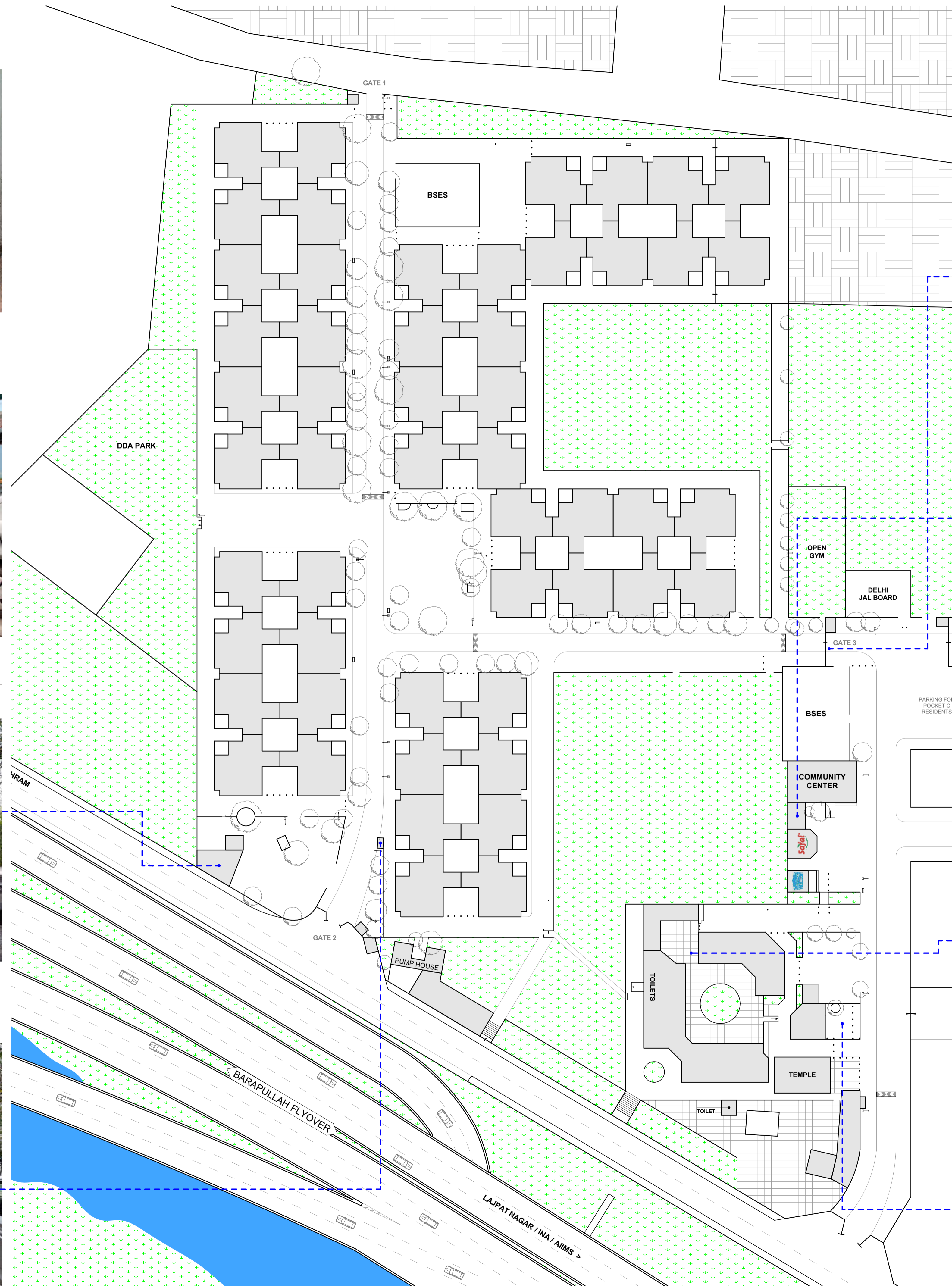

LOCATION MAP (NTS)
Siddhartha Extension
28°34'52.10"N 77°15'36.67"E

NOTE:
SUBMITTED BY THE R.W.A.

LEGEND

	TREE
	STREET LIGHTS
	BUILDING
	COLONY GATE KEPT OPEN
	COLONY GATE KEPT CLOSED
	SPEED BREAKER

PARKING AREA MANAGEMENT PLAN
SIDDHARTHA EXTN.
POCKET - B
PROBLEMS

ALL DIMENSIONS IN:	SHEET	2/5
SCALE: 1 : 500 (SHEET A1)		
SOUTH ZONE:		
SUPERINTENDING ENGINEER	EXECUTIVE ENGINEER	
ASSISTANT ENGINEER	JUNIOR ENGINEER	
R.P. CELL:		
TRANSPORT CONSULTANT	A.C. RP CELL	
A.O. RP CELL	AREA INSPECTOR	JR. ENGINEER
DATE: 3rd January 2021		
 SOUTH DELHI MUNICIPAL CORPORATION		

PARKING DEMAND

NO. OF RESIDENTIAL BLOCKS	13
NO. OF FLATS IN EACH BLOCK	16
TOTAL FLATS	208

CAR OWNERSHIP DETAILS

NO. OF FAMILIES WITH 1 CAR	90
NO. OF FAMILIES WITH 2 CARS	64
NO. OF FAMILIES WITH 3 CARS	7
NO. OF FAMILIES WITH 4 CARS	0
NO. OF FAMILIES WITH 5 CARS	1

NO. OF CARS

1 st CAR OF THE FAMILIES	162
2 nd CAR OF THE FAMILIES	72
TO PLAN FOR	234
3 rd CAR OF THE FAMILIES	8
4 th CAR OF THE FAMILIES	1
5 th CAR OF THE FAMILIES	1
TOTAL CARS OVERALL	244

THESE FIGURES ARE SUBJECT TO CHANGE OVER THE TIME

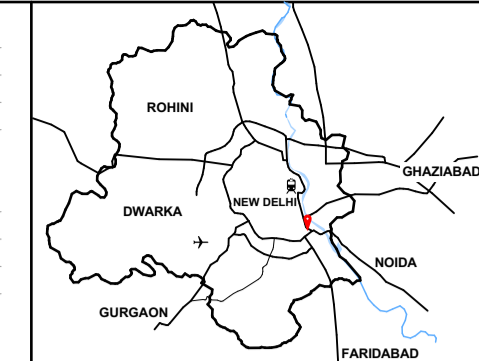

28°34'52.10"N 77°15'36.67"E

NOTE:
PROVIDED BY THE R.W.A.

LEGEND

	TREE
	STREET LIGHTS
	BUILDING
	COLONY GATE KEPT OPEN
	COLONY GATE KEPT CLOSED
	SPEED BREAKER

**PARKING AREA MANAGEMENT PLAN
SIDDHARTHA EXTN.
POCKET - B
PARKING DEMAND**

ALL DIMENSIONS IN: SHEET **3/5**
SCALE: 1 : 500 (SHEET A1)

SOUTH ZONE:

SUPERINTENDING ENGINEER	EXECUTIVE ENGINEER	
ASSISTANT ENGINEER	JUNIOR ENGINEER	
R.P. CELL:		
TRANSPORT CONSULTANT	A.C. RP CELL	
A.O. RP CELL	AREA INSPECTOR	JR. ENGINEER
DATE: 3rd January 2021		
SOUTH DELHI MUNICIPAL CORPORATION		

PARKING PLANNED AS PER FEASIBILITY ON THE GROUND.
THE NAME OF SHOPS, BUILDINGS AND LANDMARKS MAY / MAY NOT CHANGE WITH THE PASSAGE OF TIME.

TRANSPORT
AUTHORITY
SARAI KALE KHAN

TO IMPLEMENT:

- DUMPED VEHICLES TO BE TOWED AWAY**
- DIESEL CARS MORE THAN 10 YEARS OLD TO BE IDENTIFIED AND TOWED**
- PETROL CARS MORE THAN 15 YEARS OLD TO BE IDENTIFIED AND TOWED**
- BOLLARDS TO BE PUT AT CERTAIN AREAS TO BLOCK THE ENTRY OF VEHICLES.**
- SOME OF THE STRUCTURES (INDICATED IN RED) MAY BE DEMOLISHED.**
- OBJECTS CREATING VISUAL CLUTTER (HOARDINGS, ADVERTISEMENTS ETC.) TO BE REMOVED**
- GATE NO. 3 TO BE MANNED AND KEPT OPEN.**
- ILLEGAL TAXI STAND RUNNING IS TO BE REMOVED. 10 CARS CAN GET PARKED AT THAT SPOT.**
- THE PARKING INSTRUCTIONS TO BE FOLLOWED AS PER THE PLAN.**
- R.W.A. WILL ISSUE THE COLOURED STICKERS FOR THE VEHICLES. FIRST CAR, SECOND CAR, THIRD AND BEYOND CARS OF THE RESIDENTS TO BE IDENTIFIED BY DIFFERENT COLOURS.**
- RESIDENTS OF POCKET-C CANNOT PARK IN THE PREMISES OF POCKET-B AND VICE VERSA.**
- VISITORS' PARKING SPACE WILL BE OUTSIDE THE POCKET-B COLONY.**

HOARDINGS THAT CREATE VISUAL CLUTTER ARE TO BE REMOVED FROM THE ENTIRE COLONY:



STRUCTURES THAT CORPORATION MAY DEMOLISH:



ILLEGAL BUILDING

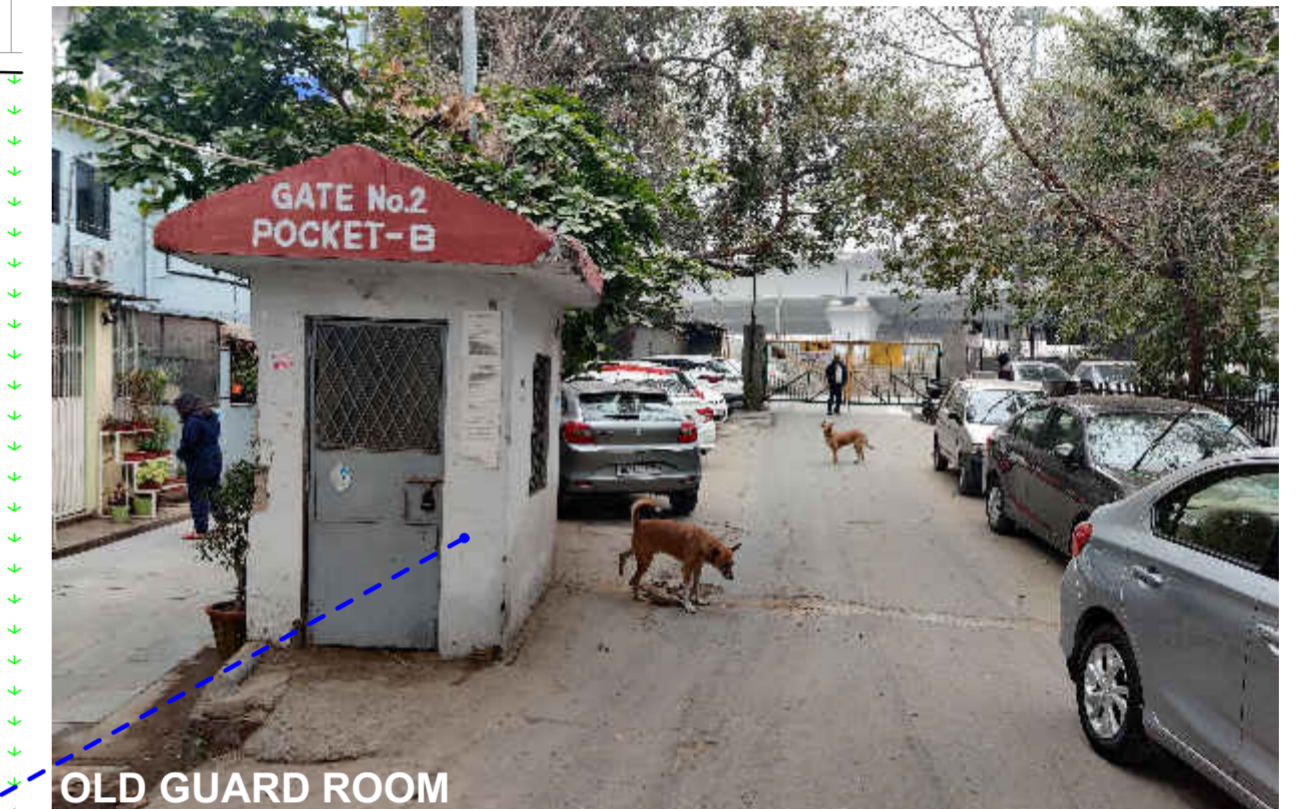

OLD GUARD ROOM



ILLEGAL CAGED STRUCTURE

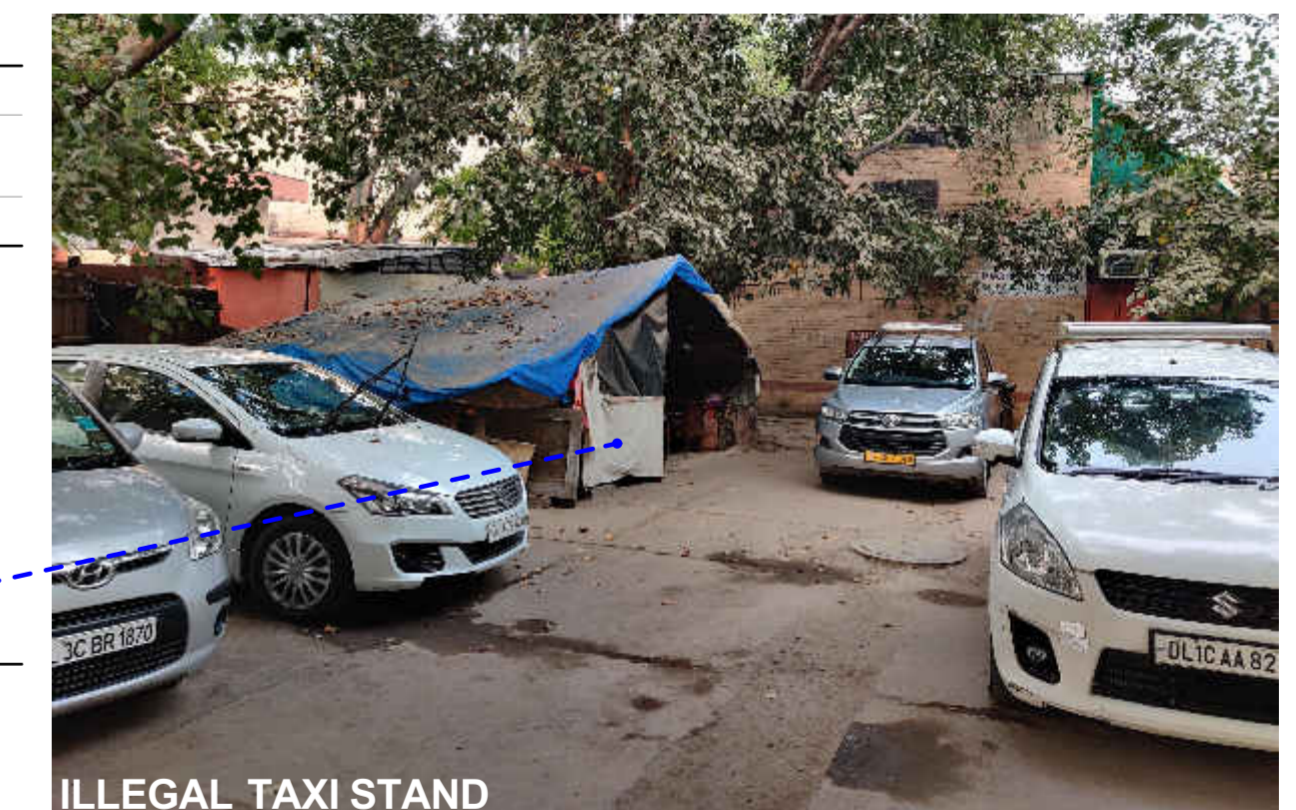

ILLEGAL TAXI STAND



PLATFORM

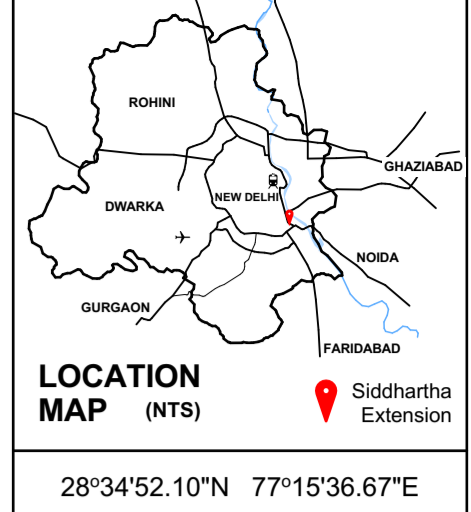

NOTE:
SUGGESTED BY THE R.W.A.

TO DEMOLISH / REMOVE

- LEGEND**
- TREE
 - STREET LIGHTS
 - BUILDING
 - COLONY GATE KEPT OPEN
 - COLONY GATE KEPT CLOSED
 - SPEED BREAKER

**PARKING AREA MANAGEMENT PLAN
SIDDHARTHA EXTN.
POCKET - B
TO IMPLEMENT**

ALL DIMENSIONS IN:	SHEET	4/5
SCALE: 1 : 500 (SHEET A1)		
SOUTH ZONE:		
SUPERINTENDING ENGINEER	EXECUTIVE ENGINEER	
ASSISTANT ENGINEER	JUNIOR ENGINEER	
R.P. CELL:		
TRANSPORT CONSULTANT	A.C. RP CELL	
A.O. RP CELL	AREA INSPECTOR	JR. ENGINEER
DATE:	3rd January 2021	
SOUTH DELHI MUNICIPAL CORPORATION		

PARKING ZONE

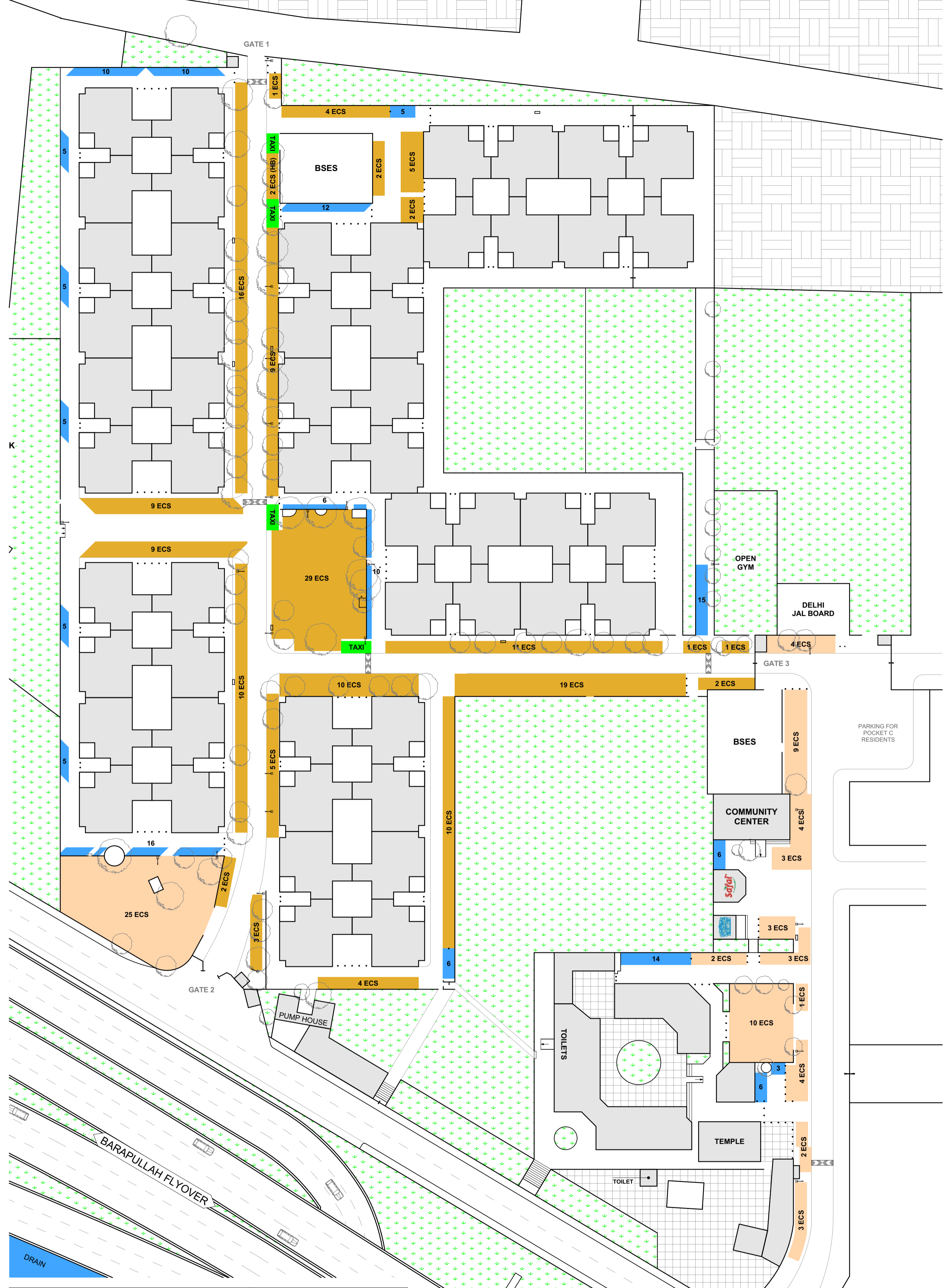

1st CAR PARKING ZONE	166
2nd CAR PARKING ZONE	73
2-WHEELER PARKING ZONE	144 (115 - RESIDENTIAL AND 29 - COMMERCIAL AR.)

PARKING LAYOUT



28°34'52.10"N 77°15'36.67"E

NOTE:
 FIRST AND SECOND CARS OWNED BY THE FAMILIES ARE BEING ACCOMMODATED INSIDE THE COLONY.
 FAMILIES HAVING 3 OR MORE CARS WILL HAVE TO PARK THEIR 3rd OR MORE CARS OUTSIDE THE COLONY.
 VISITORS' PARKING WILL BE OUTSIDE THE COLONY.
 R.W.A. WILL DECIDE THE STICKER COLOUR CODING FOR 1st AND 2nd CARS.
 R.W.A. WILL UNDERTAKE THE DISTRIBUTION OF THE STICKERS.

- 1st CAR PARKING ZONE
- 2nd CAR PARKING ZONE
- 2-WHEELER PARKING
- HB HATCH BACK

- LEGEND**
- TREE
 - BOLLARDS
 - CAR PARKING BAY
 - STREET LIGHTS
 - PARALLEL CAR PARKING BAY
 - BUILDING
 - 2-WHEELER PARKING
 - COLONY GATE KEPT OPEN
 - NO PARKING
 - COLONY GATE KEPT CLOSED

**PARKING AREA MANAGEMENT PLAN
 SIDDHARTHA EXTN.
 POCKET - B
 PARKING PLAN**

ALL DIMENSIONS IN: SHEET **5/5**
 SCALE: 1 : 500 (SHEET A1)

SOUTH ZONE:

SUPERINTENDING ENGINEER EXECUTIVE ENGINEER
 ASSISTANT ENGINEER JUNIOR ENGINEER

R.P. CELL:
 TRANSPORT CONSULTANT A.C. RP CELL

A.O. RP CELL AREA INSPECTOR JR. ENGINEER

DATE: 3rd January 2021

