



## EAST DELHI MUNICIPAL CORPORATION

(Remunerative Project Cell)

Udyog Sadan, 419, First Floor,  
Patparganj Industrial Area,  
Delhi-110092.

No. AO (R.P Cell)/EDMC/2020/D-132

Dated: 26.08.2020

### CORRIGENDUM

**Subject: - Regarding Surface Parking NIT No. 98 dated 14.08.2020.**

Kindly refer the Surface Parking NIT No. 98 dated 14.08.2020, few corrections have been made and new sites are added in NIT list: -

| Sl. No | Name of the parking site  | Land owning agency | Area in Sq. Mtr. | NOC obtained or not | MRP (in Rs. Per month) |
|--------|---|--------------------|------------------|---------------------|------------------------|
| 1      | Near Shamshan Ghat Geeta Colony   | DDA                | 2788             | No                  | 324000                 |
| 2      | Near Anand Vihar Railway Station  | DDA                | 1050             | No                  | 72450                  |
| 3      | Additional Vacant land, Near BSES Azad Nagar                              | DDA                | 390              | No                  | 18333                  |
| 4      | Ghazipur Subji Mandi  | DDA                | 1648             | Yes                 | 308815                 |
| 5      | In-front of Central ware House Godown, Gazipur                            | DDA                | 20000            | Yes                 | 539520                 |
| 6      | 3 <sup>rd</sup> Pusta Old Usmanpur Village.                               | DDA                | 1465             | Yes                 | 56870                  |
| 7      | Near Gurudwara, Lalita Park Laxmi Nagar                                   | DDA                | 1050             | Yes                 | 136223                 |
| 8      | Mix Water Pump Marginal Bandh Shahdara *                                  | PWD                | 2350             | Yes                 | 263200                 |
| 9      | In-front of Kiosk No 15 to 19 Distt. Centre Laxmi Nagar *                 | DDA                | 2550             | Yes                 | 536908                 |
| 10     | Near East Point Public School, besides Manav Ashray, Vasundhara Enclave   | DDA                | 1440             | Yes                 | 45000                  |
| 11     | Near East Point Public School, back side Manav Ashray, Vasundhara Enclave | DDA                | 2430             | Yes                 | 76250                  |
| 12     | Adjoining Near Red Fox Hotel, Mayur Vihar Phase-III                       | DDA                | 8525             | Yes                 | 199688                 |
| 13     | Back Side of Shani Dev Mandir I.P Extension Patparganj                    | DDA                | 2731             | Yes                 | 119250                 |
| 14     | In-front of Gazipur Paper Market (near Gazipur Thana)                     | DDA                | 62350            | Yes                 | 1950000                |
| 15     | Vacant land near Old Iron Bridge Shastri Park                             | MCD                | 450              | Yes                 | 20160                  |

|    |   |     |      |     |        |
|----|---|-----|------|-----|--------|
| 16 | Vacant land behind Shahdara North Zone Office             | MCD | 730  | Yes | 33600  |
| 17 | S. Kumar Banquet Hall, Near TATA Telco                    | DDA | 2625 | Yes | 120000 |
| 18 | Shashi Garden, near Post Office                           | DDA | 2158 | Yes | 98880  |
| 19 | Behind CNG Pump, Near Paper Market, Gazipur               | DDA | 970  | No  | 40320  |
| 20 | Under Flyover Khajuri Chowk                               | PWD | 2080 | No  | 95040  |
| 21 | Under boundary Wall, Babarpur                             | DDA | 1151 | Yes | 126475 |
| 22 | Under Flyover Khajuri, Wazirabad Side                     | PWD | 2600 | No  | 119040 |
| 23 | Around Le – Diamond Banquet Hall, Yamuna Vihar            | DDA | 7800 | No  | 356160 |
| 24 | Backside Temple & Mosque, Near Mohalla Clinic, New Kondli | DDA | 3540 | No  | 162240 |

  
 26/8/2020  
**Assistant Commissioner**  
**R.P. Cell, EDMC**

**AO/IT - with request to upload this  
on EDMC website for information  
to prospective bidders.**

Today itself  
 26/8/2020  
 Chai Neeraj

# UNDER FLYOVER KHAJURI CHOWK, WAZIRABAD SIDE

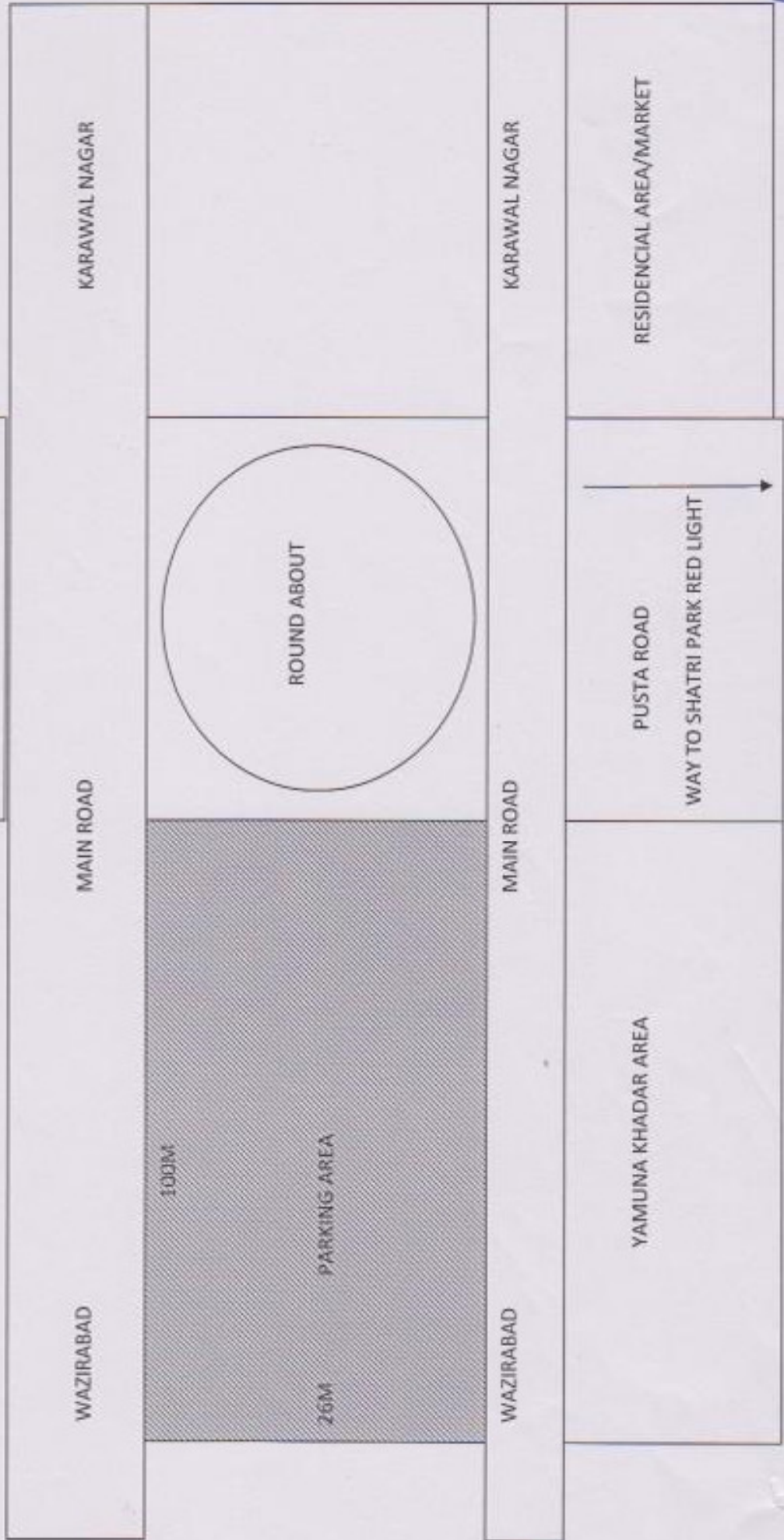

# AROUND LE DIAMOND BANQUET HALL, YAMUNA VIHAR

RESIDENCIAL AREA

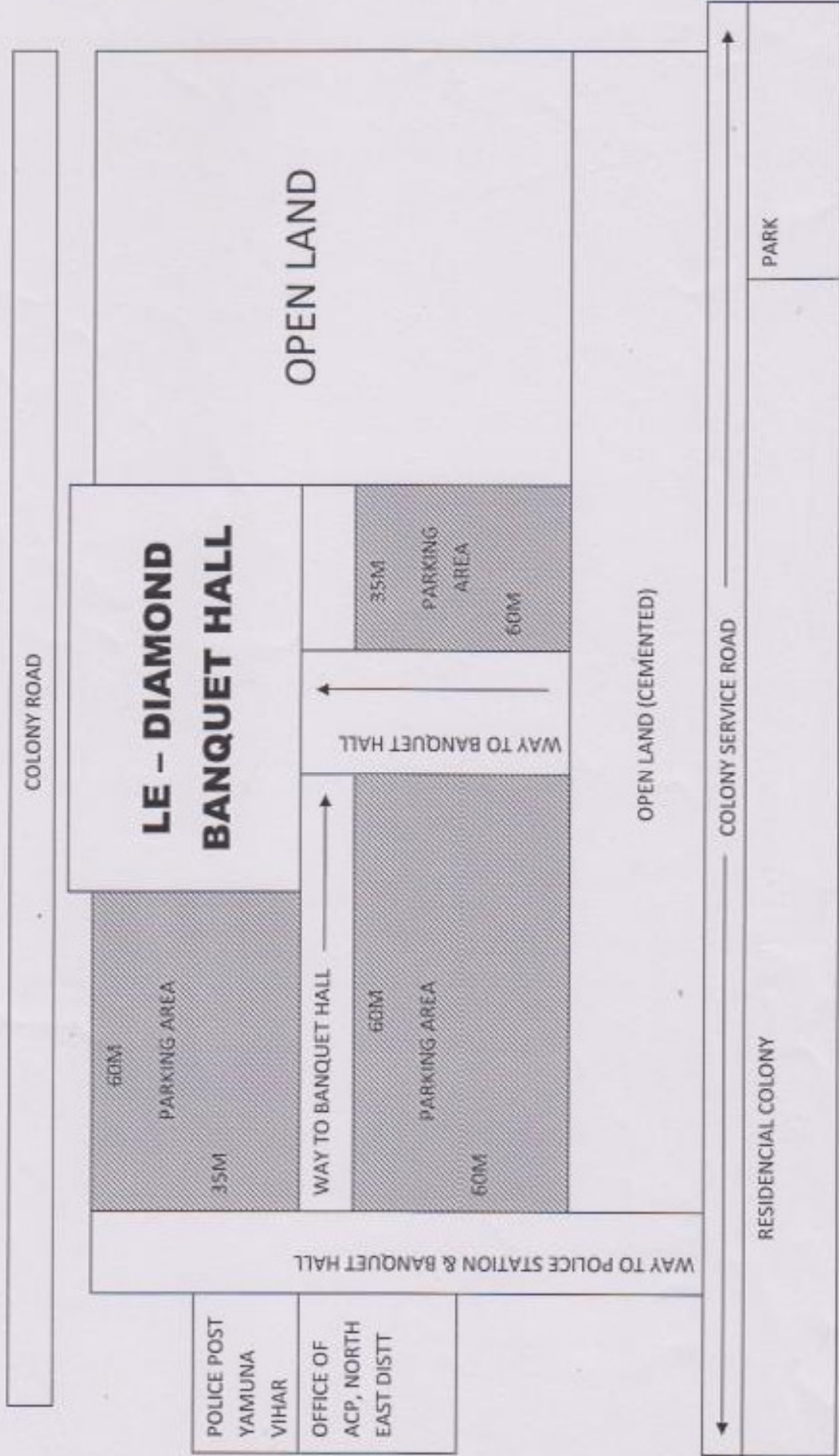

*Handwritten signature/initials*

*Handwritten number 255*

BACKSIDE TEMPLE & MOSQUE, NEAR MOHALLA CLINIC, NEW KONDLI.

562

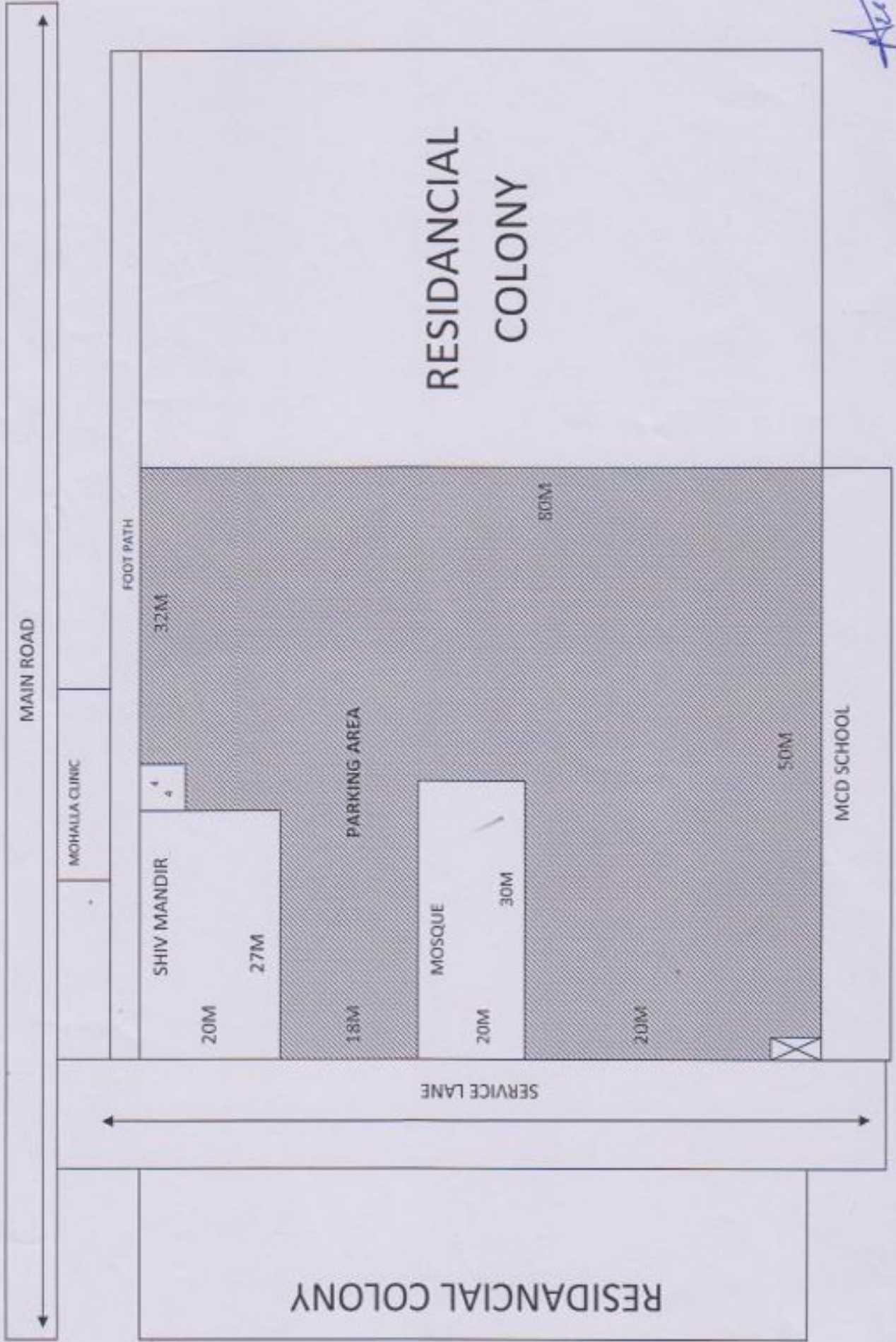

A. B. 10/10