

**ARCHITECTURAL WING.
P.W.D. DELHI ADMN. DELHI.**

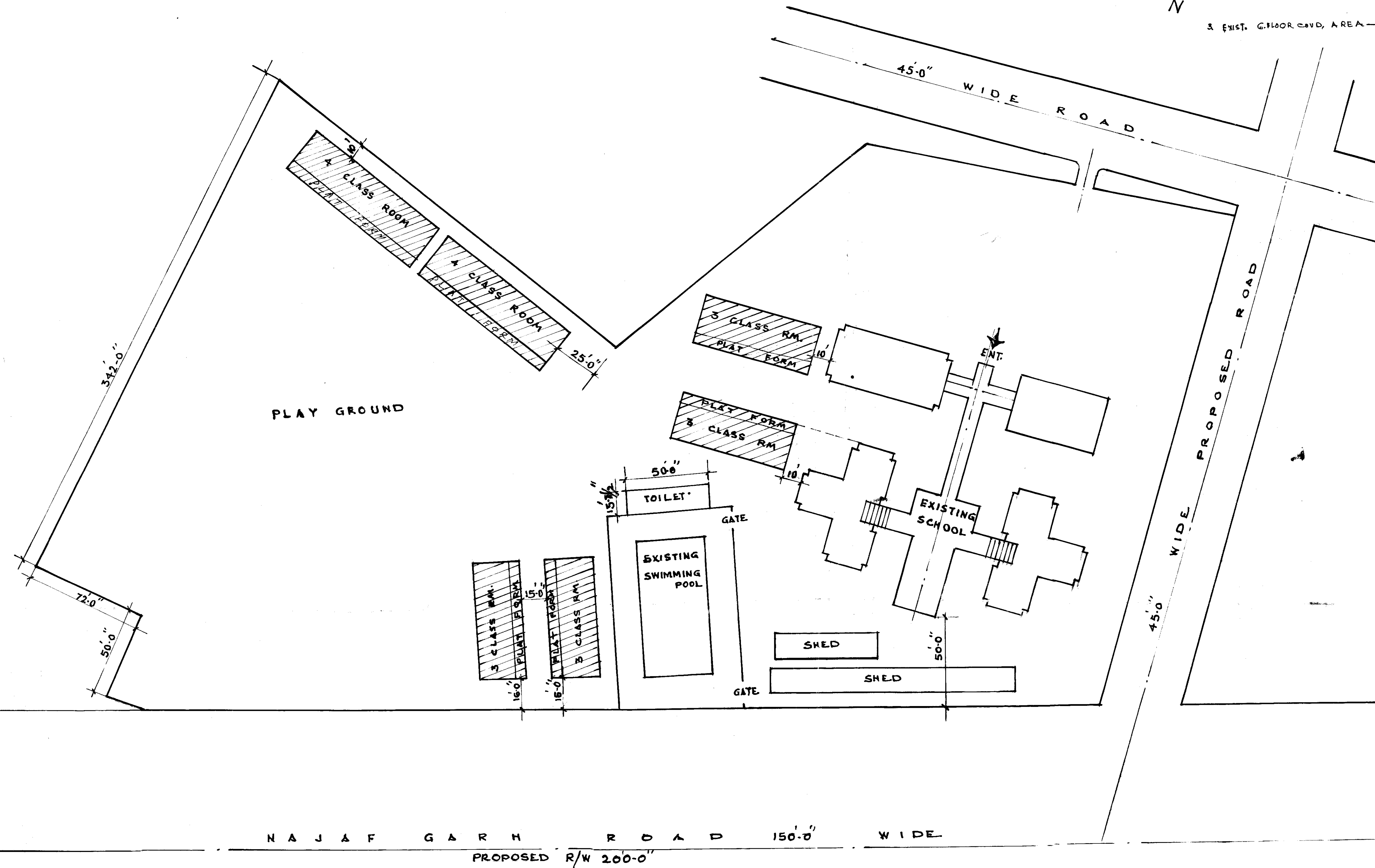
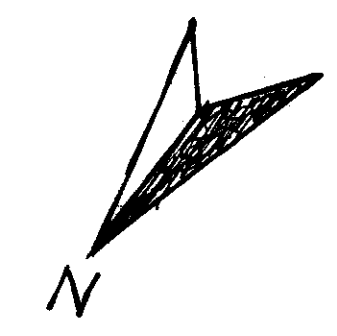

PROPOSED CLASS ROOM 20 NOS.
NOTE:- PROPOSED CLASS ROOMS SHOWN THUS
AREA CHART
1. AREA OF PLOT = 217800 SFT.
2. EXISTING GROUND FLOOR COVERED AREA 11603 SFT.
3. (FOR TEMP. CLASS ROOMS) 1284 SFT.
4. PROPOSED GROUND FLOOR COVERED AREA 25593.50 SFT.
TOTAL COVERED AREA ON GROUND FLOOR 25593.50 SFT.
GROUND FLOOR COVERAGE 11.75%
EXISTING COVERED AREA ON FIRST FLOOR 6280 SFT.
EXISTING COVERED AREA ON 2ND FLOOR 6280 SFT.
EXISTING COVERED AREA ON 3RD FLOOR 6280 SFT.
F.A.R. $(\frac{25593 + 18840}{217800}) \times 100 = 20.40$

CONSTRUCTION OF 20 TEMP. CLASS ROOMS IN THE COMPOUND OF GOVT. HR. SEC. SCHOOL AT RAJOURI GARDEN N. DELHI APPROVED BY THE STANDING COMMITTEE VIDE RS SOLUTION NO. 667 DATED 6.12.78 SUBJECT TO THE CONDITION OF APPROVAL:-
I. BLDG. PLANS SHALL BE GOT APPROVED FROM THE BLDG. BYE LAWS AND ZONING REGULATIONS OF MASTER PLANS.
II. SERVICE SHALL BE LAID AND MAINTAINED BY P.W.D. AS PER M.C.D. STANDARD.
III. THE APPLICANT SHALL LEAVE A PORTION OF LAND IF AFFECTED IN R/W OF ADJOINING ROADS AND SHALL BE HANDED OVER TO M.C.D. FREE OF COST WHEN ASKED FOR.
IV. APPROVAL OF URBAN ART COMMISSION WILL HAVE TO BE OBTAINED BY THE APPLICANT BEFORE GETTING THE BLDG. PLANS SANCTIONED FROM THE BUILDING DEPTT. OF M.C.D.
V. SET BACKS SHALL BE AS PER BLDG. BYE LAWS.

J. Town Planner
J. TOWN PLANNER (L) TOWN PLANNER
16.3.79

SENIOR ARCHITECT UNIT-II

DRG. NO. SA/DA-II/1589. SCALE 32'-0" = 1" INCH
S. B. Mathur
ARCHITECTURAL ASST. GC.

GOVT. HR. SECONDARY SCHOOL AT RAJOURI GARDEN NEW DELHI LAY-OUT PLAN.

D. J. Hirani (D.J. HIRANI) ASST. ARCHITECT
S. B. Mathur (S.B. MATHUR) ARCHITECT.

sd: (T.K.D. BARMAN) SENIOR ARCHITECT.