

N.R.H.Q.E.(P) PLAN No. 358/1958
 SPECIAL PLAN, NR. 358/1958
 NORTHERN RAILWAY
 DRAWING OFFICE, SEWAPUR, RAJASTHAN

APPROVAL OF LAYOUT PLAN OF
 RAILWAY COLONY AT PUNJAB BAH
 NEAR ROHTAK ROAD NEW DELHI
 APPROVED BY THE COMMISSIONER
 WIDE DICTION NR. 26/9/57S, DATED 30-1-57

SCALE - 1/8" = 1' INCH
 CASE NO. 1133-W/51/SPL
 C/SEEN PLAN NR.
 5/SEN/SPL CASE NR. 1133-W/51/SPL

CONDITIONS
 1. THE APPLICANT SHALL BE RESPONSIBLE FOR THE PROVISION OF ALL SERVICES AND UTILITIES REQUIRED FOR THE DEVELOPMENT OF THE SITE.
 2. THE APPLICANT SHALL BE RESPONSIBLE FOR THE PROVISION OF ALL SERVICES AND UTILITIES REQUIRED FOR THE DEVELOPMENT OF THE SITE.
 3. THE APPLICANT SHALL BE RESPONSIBLE FOR THE PROVISION OF ALL SERVICES AND UTILITIES REQUIRED FOR THE DEVELOPMENT OF THE SITE.

APPROVED BY THE COMMISSIONER
 WIDE DICTION NR. 26/9/57S, DATED 30-1-57

APPROVED BY THE COMMISSIONER
 WIDE DICTION NR. 26/9/57S, DATED 30-1-57

THE VARIOUS DETAILS OF THE PROPOSAL ARE GIVEN AS UNDER

TYPE	NO. OF BLOCKS	AREA OF EACH BLOCK IN SQ. FT.	TOTAL AREA IN SQ. FT.	NO. OF UNITS
I	15	16,000	240,000	150
II	15	16,000	240,000	150
III	15	16,000	240,000	150

POPULATION 4500
 DENSITY 150 PER ACRE
 TOTAL COVERED AREA 720,000 SQ. FT.
 TOTAL AREA OF THE SCHEME 20,92,858 SQ. FT.
 ARE UNDER THE SCHEME 20,92,858 SQ. FT.

DETAILS OF COVERED AREA

TYPE	NUMBER OF BLOCKS	COVERED AREA IN SQ. FT.	PERCENTAGE OF TOTAL COVERED AREA
I	15	240,000	33.33
II	15	240,000	33.33
III	15	240,000	33.33

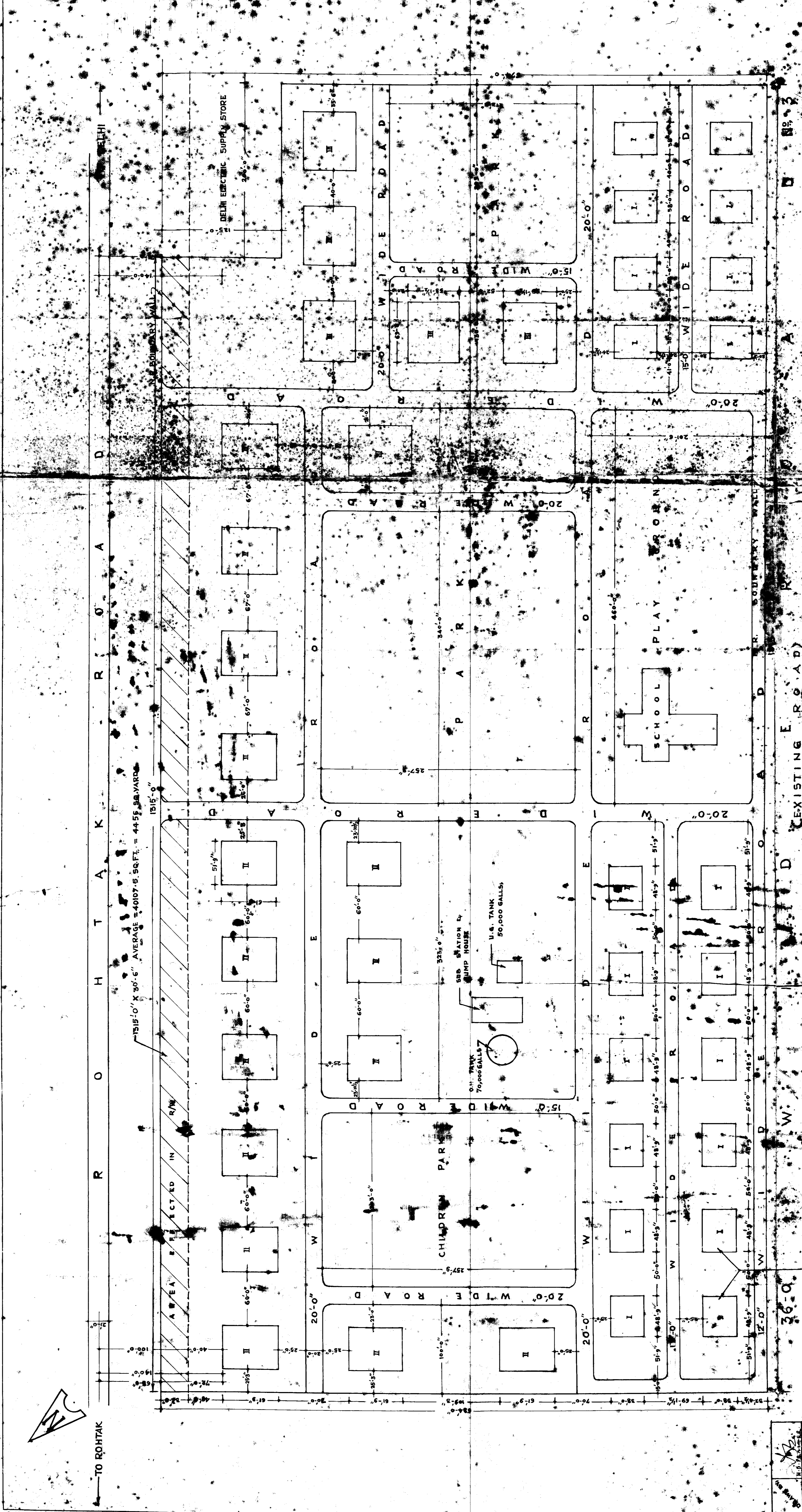

EXISTING ROAD

ROAD NO. 12

ROAD NO. 13

ROAD NO. 14

ROAD NO. 15

ROAD NO. 16

ROAD NO. 17

ROAD NO. 18

ROAD NO. 19

ROAD NO. 20

ROAD NO. 21

ROAD NO. 22

ROAD NO. 23

ROAD NO. 24

ROAD NO. 25

ROAD NO. 26

ROAD NO. 27

ROAD NO. 28

ROAD NO. 29

ROAD NO. 30

ROAD NO. 31

ROAD NO. 32

ROAD NO. 33

ROAD NO. 34

ROAD NO. 35

ROAD NO. 36

ROAD NO. 37

ROAD NO. 38

ROAD NO. 39

ROAD NO. 40

ROAD NO. 41

ROAD NO. 42

ROAD NO. 43

ROAD NO. 44

ROAD NO. 45

ROAD NO. 46

ROAD NO. 47

ROAD NO. 48

ROAD NO. 49

ROAD NO. 50

ROAD NO. 51

ROAD NO. 52

ROAD NO. 53

ROAD NO. 54

ROAD NO. 55

ROAD NO. 56

ROAD NO. 57

ROAD NO. 58

ROAD NO. 59

ROAD NO. 60

ROAD NO. 61

ROAD NO. 62

ROAD NO. 63

ROAD NO. 64

ROAD NO. 65

ROAD NO. 66

ROAD NO. 67

ROAD NO. 68

ROAD NO. 69

ROAD NO. 70

ROAD NO. 71

ROAD NO. 72

ROAD NO. 73

ROAD NO. 74

ROAD NO. 75

ROAD NO. 76

ROAD NO. 77

ROAD NO. 78

ROAD NO. 79

ROAD NO. 80

ROAD NO. 81

ROAD NO. 82

ROAD NO. 83

ROAD NO. 84

ROAD NO. 85

ROAD NO. 86

ROAD NO. 87

ROAD NO. 88

ROAD NO. 89

ROAD NO. 90

ROAD NO. 91

ROAD NO. 92

ROAD NO. 93

ROAD NO. 94

ROAD NO. 95

ROAD NO. 96

ROAD NO. 97

ROAD NO. 98

ROAD NO. 99

ROAD NO. 100

TO ROHTAK

1315'-0" X 30'-6" AVERAGE = 4007'-6.56 FT. = 4455 SQ. YARDS

1315'-0"

AB AREA SELECTED IN 1/4"

DELINE ELECTRIC SUPPLY STORE

CHILDREN PARK

SCHOOL PLAY GROUND

U.S. TANK 50,000 GALLS

PUMP HOUSE

ROADS: ROHTAK ROAD, P.A.R.K. ROAD, D.E.R. ROAD, W.I.D.E.R.O.A.D.

Block labels: I, II, III

Dimensions: 20'-0", 15'-0", 12'-0", 10'-0", 8'-0", 6'-0", 4'-0", 2'-0"

EXISTING ROAD

ROAD NO. 12

ROAD NO. 13

ROAD NO. 14

ROAD NO. 15

ROAD NO. 16

ROAD NO. 17

ROAD NO. 18

ROAD NO. 19

ROAD NO. 20

ROAD NO. 21

ROAD NO. 22

ROAD NO. 23

ROAD NO. 24

ROAD NO. 25

ROAD NO. 26

ROAD NO. 27

ROAD NO. 28

ROAD NO. 29

ROAD NO. 30

ROAD NO. 31

ROAD NO. 32

ROAD NO. 33

ROAD NO. 34

ROAD NO. 35

ROAD NO. 36

ROAD NO. 37

ROAD NO. 38

ROAD NO. 39

ROAD NO. 40

ROAD NO. 41

ROAD NO. 42

ROAD NO. 43

ROAD NO. 44

ROAD NO. 45

ROAD NO. 46

ROAD NO. 47

ROAD NO. 48

ROAD NO. 49

ROAD NO. 50

ROAD NO. 51

ROAD NO. 52

ROAD NO. 53

ROAD NO. 54

ROAD NO. 55

ROAD NO. 56

ROAD NO. 57

ROAD NO. 58

ROAD NO. 59

ROAD NO. 60

ROAD NO. 61

ROAD NO. 62

ROAD NO. 63

ROAD NO. 64

ROAD NO. 65

ROAD NO. 66

ROAD NO. 67

ROAD NO. 68

ROAD NO. 69

ROAD NO. 70

ROAD NO. 71

ROAD NO. 72

ROAD NO. 73

ROAD NO. 74

ROAD NO. 75

ROAD NO. 76

ROAD NO. 77

ROAD NO. 78

ROAD NO. 79

ROAD NO. 80

ROAD NO. 81

ROAD NO. 82

ROAD NO. 83

ROAD NO. 84

ROAD NO. 85

ROAD NO. 86

ROAD NO. 87

ROAD NO. 88

ROAD NO. 89

ROAD NO. 90

ROAD NO. 91

ROAD NO. 92

ROAD NO. 93

ROAD NO. 94

ROAD NO. 95

ROAD NO. 96

ROAD NO. 97

ROAD NO. 98

ROAD NO. 99

ROAD NO. 100