

LAYOUT PLAN OF CENTRAL HIGHER SECONDARY SCHOOL AT ANDREWS GANJ, DELHI.  
 APPROVED BY THE STANDING COMMITTEE OF MUNICIPAL CORPORATION OF DELHI.  
 VIDE RESOLUTION NO. 146 DATED 28-5-69 SUBJECT TO CONDITIONS

GIVEN  
*[Signature]*  
 TOWN PLANNER

7.2.74  
 TOWN PLANNER

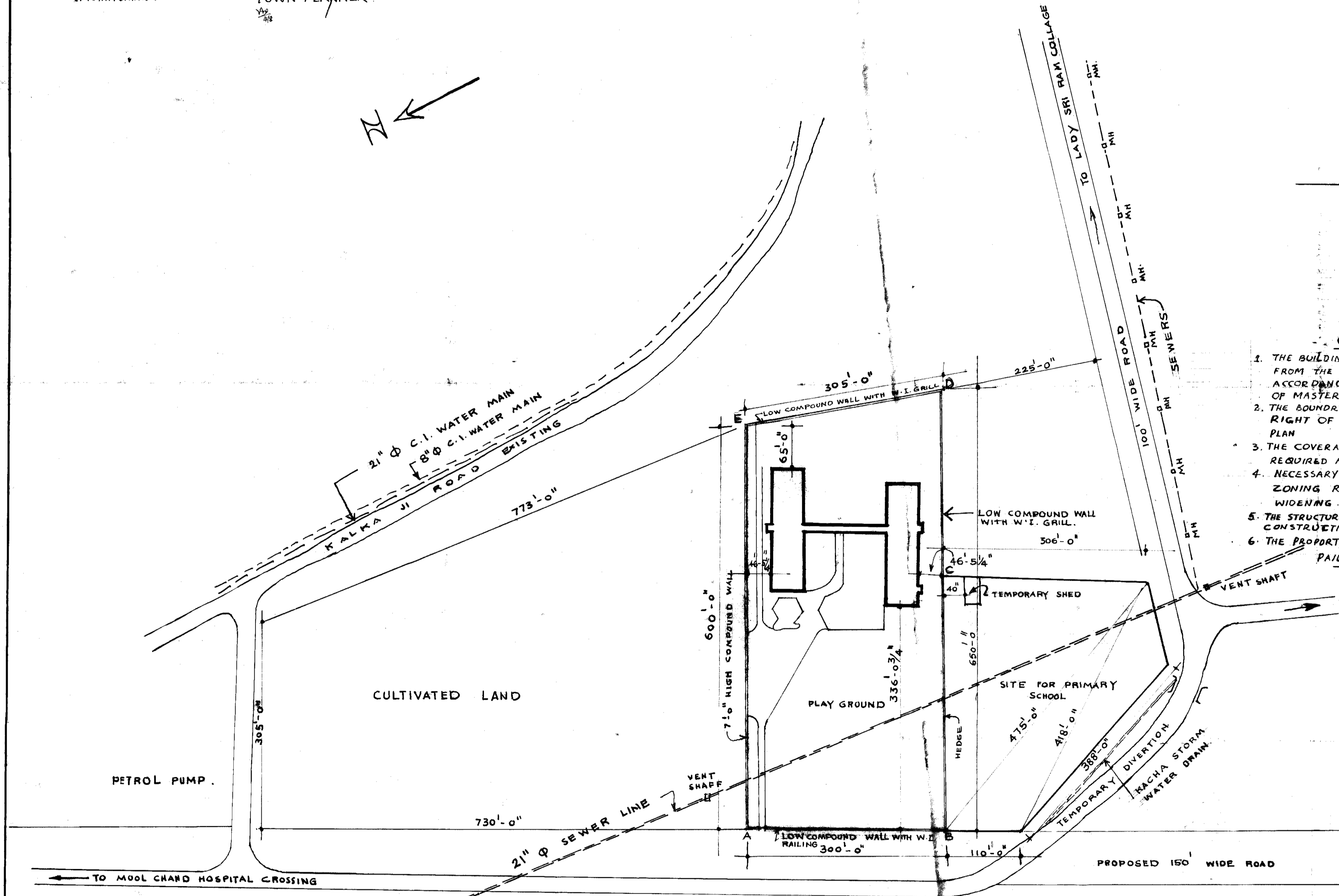
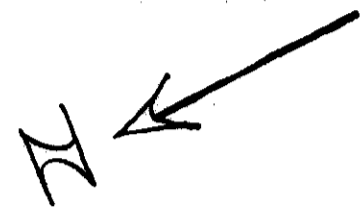

**NOTE -**  
 FOR GROUND FLOOR, FIRST FLOOR, SECOND FLOOR AND TERRACE PLAN REFER DRG NO B-II-180/9103, 9104, 9105, 9116 RESPECTIVELY.  
 FOR ELEVATIONS, SECTIONS AND SECTIONAL ELEVATION REFER DRG NO. B-II-180/9106 AND 9107  
 FOR TEMPORARY SHED REFER DRG NO B-II-180/9111  
 1. A TO E 7'-0" HIGH COMPOUND WALL.  
 2. E TO D, D TO C & A TO B LOW COMPOUND WALL WITH W.I. GRILL  
 3. B TO C HEDGE.

THE VARIOUS DETAILS OF THE SCHEME ARE AS UNDER :-

|                                 |              |
|---------------------------------|--------------|
| 1. AREA OF THE SITE             | 4.23 ACRES.  |
| 2. COVERED AREA ON GROUND FLOOR | 19601 SQ.FT. |
| 3. " " " FIRST FLOOR            | 19601 SQ.FT. |
| 4. " " " 2ND FLOOR              | 8711 SQ.FT.  |
| GROUND COVERAGE                 | 10.64 %      |
| F. A. R                         | 26           |

- CONDITIONS OF APPROVAL**
1. THE BUILDING PLANS FOR THE SCHOOL BUILDING SHALL BE GOT APPROVED FROM THE BUILDING DEPARTMENT OF THE MUNICIPAL CORPORATION OF DELHI IN ACCORDANCE WITH THE PROVISIONS OF BUILDING BYE-LAWS & ZONING REGULATIONS OF MASTER PLAN BEFORE TAKING UP THE CONSTRUCTION WORK IN HAND.
  2. THE BOUNDARY AROUND THE SITE SHALL BE CONSTRUCTED AFTER ENSURING THE RIGHT OF WAY OF 150' WIDE MASTER PLAN ROAD AS PER APPROVED ALIGNMENT PLAN.
  3. THE COVERAGE AND FAR SHALL BE RECONSIDERED AFTER DEDUCTING THE AREA REQUIRED FOR ROAD WIDENING.
  4. NECESSARY SET BACK SHALL BE LEFT AS REQUIRED BY THE BUILDING BYE LAWS & ZONING REGULATIONS OF THE MASTER PLAN AFTER LEAVING THE SPACE FOR ROAD WIDENING.
  5. THE STRUCTURES ALREADY EXISTING AT SITE SHALL BE DEMOLISHED BEFORE STARTING THE CONSTRUCTION.
  6. THE PROPORTIONATE COST OF TRUNK AND CENTRALIZED SERVICES SHALL BE PAID BY THE APPLICANT.

**NOTE:-**  
 THIS LAYOUT PLAN IS BASED ON SURVEYED SITE PLAN RECEIVED FROM EXECUTIVE ENGINEER FARIDABAD CENTRAL DIVISION No II, C.P.W.D, FARIDABAD (HARIANA). VIDE LETTER No 23 (35) 68-PCO/18941-44. DATED 28-10-68

CERTIFIED TRUE COPY OF DRG. No B-II-180/9123

|  |   |
|--|---|
| <b>CENTRAL SCHOOL<br/>ANDREWS GANJ, NEW DELHI.</b>                 |   |
| <b>LAY-OUT PLAN.</b>   |   |
| DRG. No. B-II-180/9123<br>DATE 3-11-68<br>SCALE - 100 FT = 1 INCH. | DRG. No. B-II-180/9123  |
| sd/<br>(J. R. JADHAY)<br>ARCHITECT<br>C.P.W.D. NEW DELHI.          | sd/<br>(D. G. BADHIRE)<br>SENIOR ARCHITECT<br>C.P.W.D. NEW DELHI. |

M-386