

# ARCHITECTURAL - WING

P. W. D. DELHI ADMN

## SCHEDULE OF AREAS

TOTAL AREA OF THE PLOT 0.429 ACRES  
OR 18687 SQ. FT.

### EXISTING COVERED AREA

GR. FLOOR POLICE POST	2422	Sq. FT.
TYPE I QRS	1898	"
FIRST FLOOR POLICE POST	2110	"
TYPE I QRS	1898	"
2nd FLOOR POLICE POST	1817	"
TYPE I QRS	1898	"
3rd FLOOR TYPE I QRS	1898	"
<b>TOTAL</b>	<b>13941</b>	<b>Sq. FT.</b>

### PROPOSED COVERED AREA

GROUND FLOOR POLICE POST	= 386	Sq. FT. (TWO GARAGES)
SECOND FLOOR	292	" (ADDNL FINGER PRINT ROOM)
<b>TOTAL</b>	<b>678</b>	<b>"</b>

TOTAL COVERED AREA GROUND FLOOR  
2422 + 1898 + 386 = 4706 Sq. FT.  
TOTAL COVERED AREA ON ALL FLOORS  
13941 + 678 = 14620 "

COVERAGE =  $\frac{4706 \times 100}{18687} = 25.17\%$

F.A.R =  $\frac{14620 \times 100}{18687} = 78.14$

### DETAILS OF PROPOSED COVERED AREA

#### GROUND FLOOR

GARAGES NO 1  $19'6" \times 9'9" = 190'1\frac{1}{2}"$   
NO 2  $19'6" \times 9'9" = 190'1\frac{1}{2}"$   
+  $0'9" \times 7'9" = 5'9\frac{3}{4}"$   
TOTAL =  $386'0\frac{1}{2}"$  OR SAY 386 SQ. FT.

ON SECOND FLOOR =  $19'6" \times 15'0" = 292.50 = 292$  SQ. FT.

NOTE:- THE DETAILS OF AREAS HAVE BEEN TAKEN FROM  
DRG NO SA/DA/1396/1

PROPOSED WORK SHOWN THUS 

- THE LAYOUT PLAN OF THE CONSTRUCTION OF FINGER PRINTS ROOM AND TWO GARRAGES AT CRIME RECORD OFFICE AT R.K. PURAM SECTOR VIII, NEW DELHI APPROVED BY S/C VIDE RESOLUTION NO 981 DT 1/2/79. SUBJECT TO THE CONDITIONS AS FOLLOWS.
1. THE BUILDING PLANS OF THE PROPOSED BLOCKS SHALL BE GOT APPROVED FROM BUILDING DEPARTMENT OF M.C.D. BEFORE TAKING UP THE CONSTRUCTION WORK IN HAND.
  2. NECESSARY SET BACK SHALL BE LEFT AS REQUIRED UNDER S.B.L AND ZONING REGULATIONS OF MASTER PLANS.
  3. SERVICES SHALL BE LAID AND MAINTAINED BY PWD AUTHORITIES AS PER MUNICIPAL STANDARDS AND SATISFACTIONS OF COMMISSIONER M.C.D.

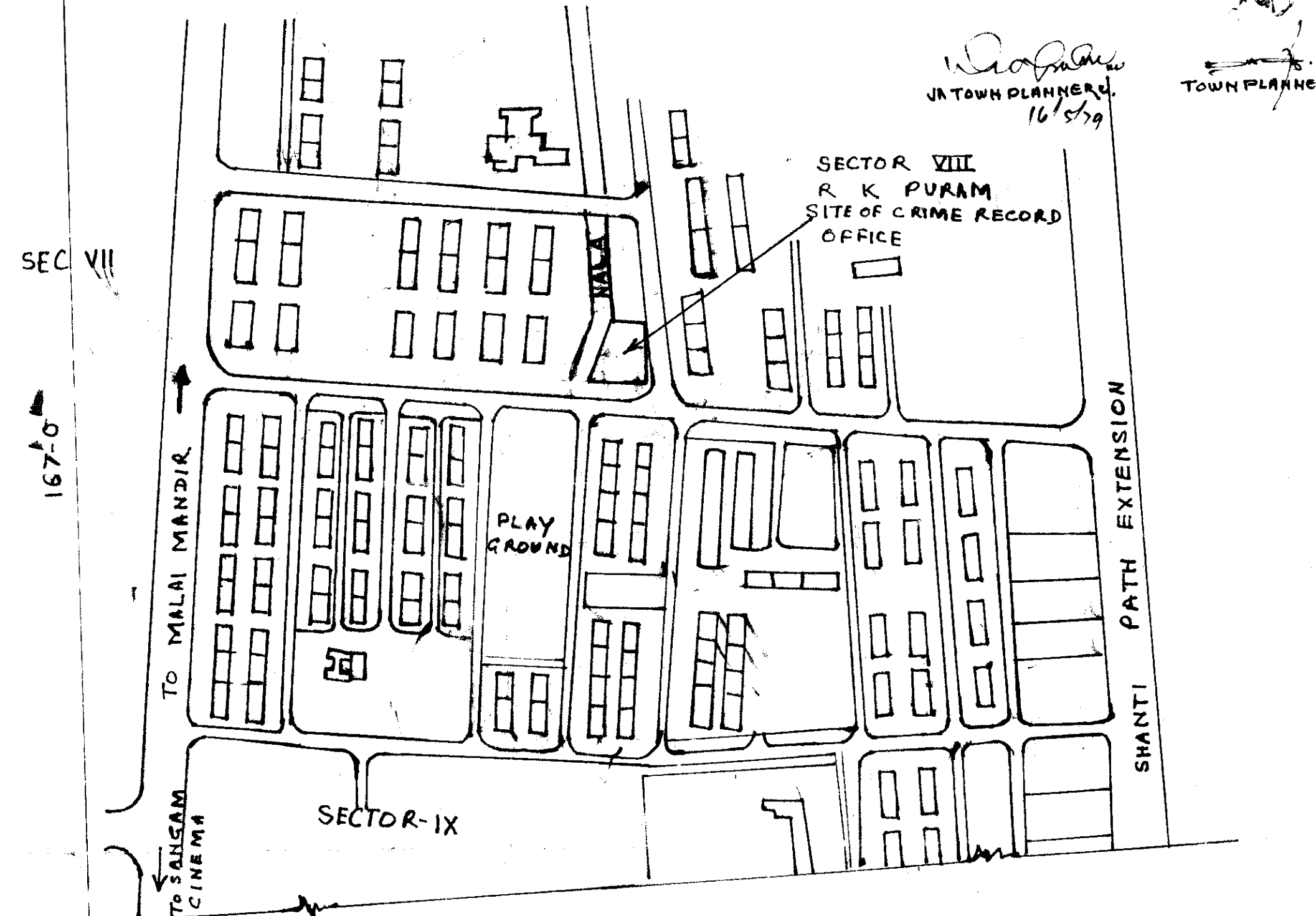

KEY PLAN  
SCALE :- 200 = 1"

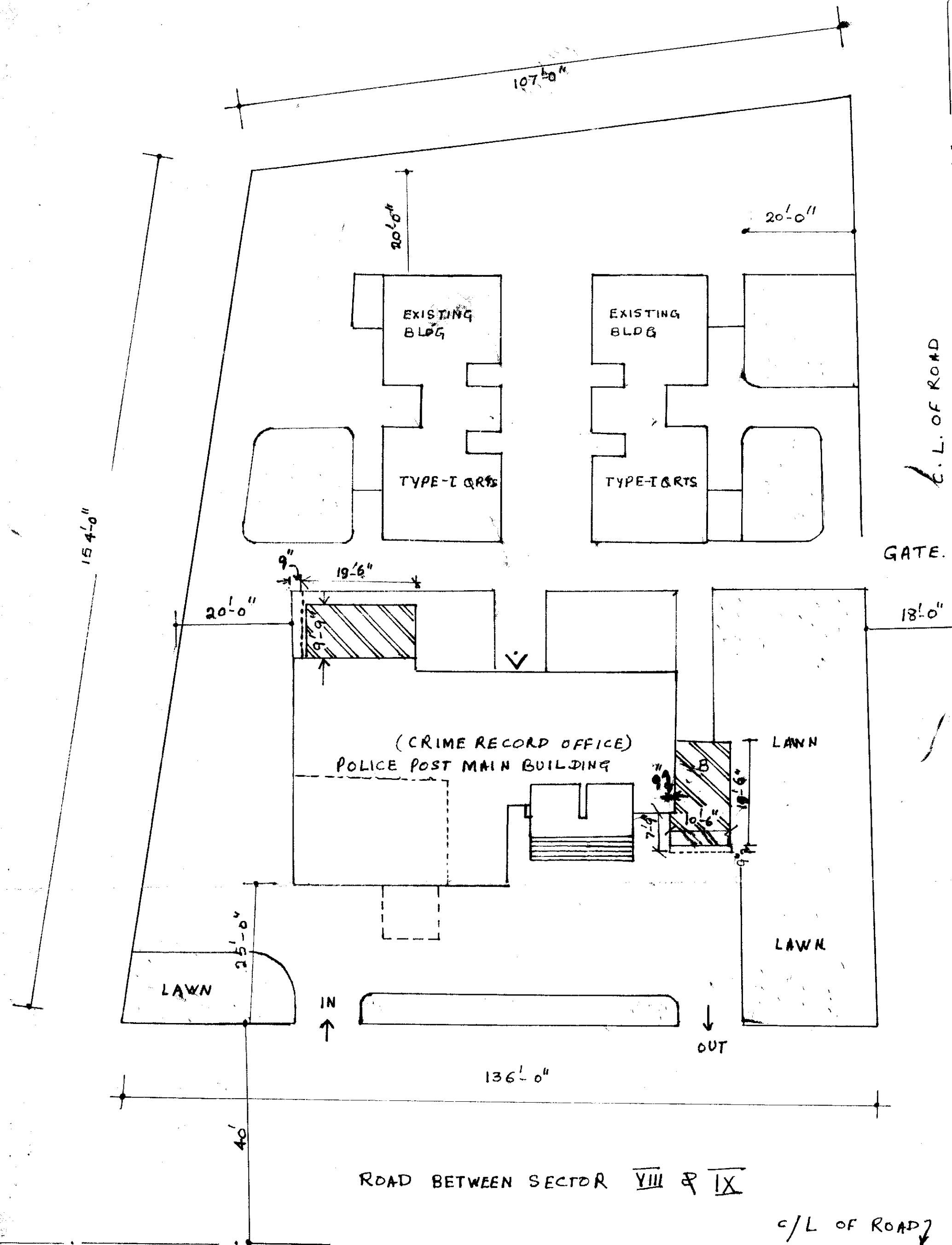

LAY OUT PLAN

## SENIOR ARCHITECT - II - UNIT

DRG NO

SCALE = 16 FEET = 1 INCH  
DATE

SA/DA-II/1391/1

RADHA CHAUDHRY

CRIME RECORD OFFICE BLDG  
AT R.K. PURAM (PROPOSED)  
GARAGES AND ADDITION OF FINGER PRINT  
ROOM ON 2nd FLOOR (LAY-OUT-PLAN)

SA/-  
R. S. VASAN  
ASSTT ARCH.

C. S. Sharma  
C.N.S. SHARMA 5/3/79  
ARCHITECT.

DRG No :- TP/M/5572  
SIZE :- 10.5 X 6.1 = 619.50 CM.

T. K. D. BARMAN.  
SENIOR ARCHITECT.