

588 W

REVISION IN THE LAY-OUT PLAN OF COLLEGE OF NURSING, LAJPAT NAGAR APPROVED BY D.C.C.S) VIDE ITEM NO 135/72, DATED 1-4-72 SUBJECT TO THE FOLLOWING DECISION THE MINOR MODIFICATIONS NECESSITATED BY CIRCUMSTANCES ARE APPROVED.

[Signature]
JR. TOWNPLANNER

APPROVED
VIDE ITEM No 135/72 DATED 1-4-72 SUBJECT TO THE CONDITIONS AS IMPOSED THERE IN FILE No. 1145/705.T.P./M.C.D.
SD/
124-72
TOWNPLANNER
MUNICIPAL CORPORATION DELHI.

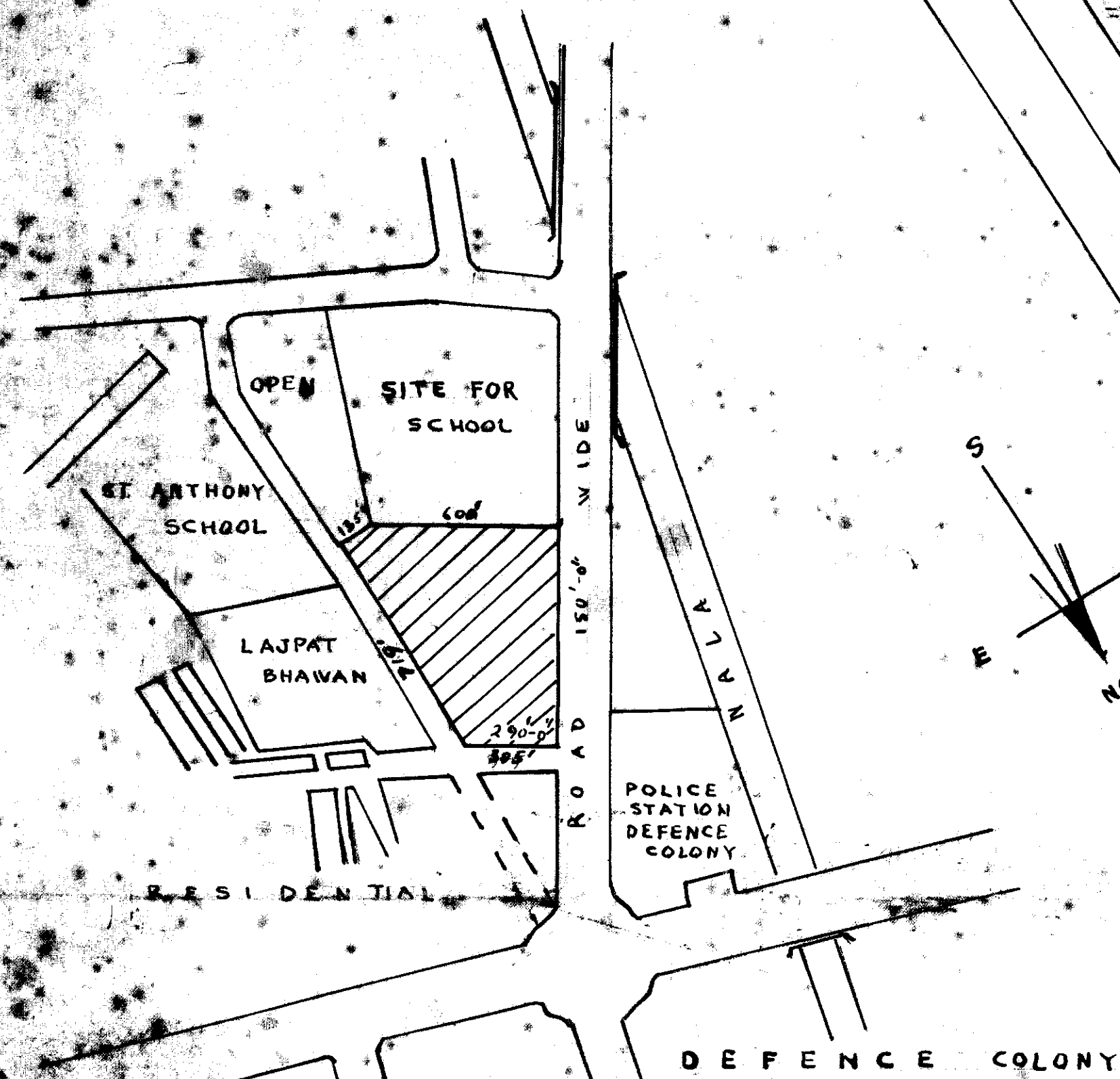

KEY PLAN
SCALE 400 FT TO AN INCH

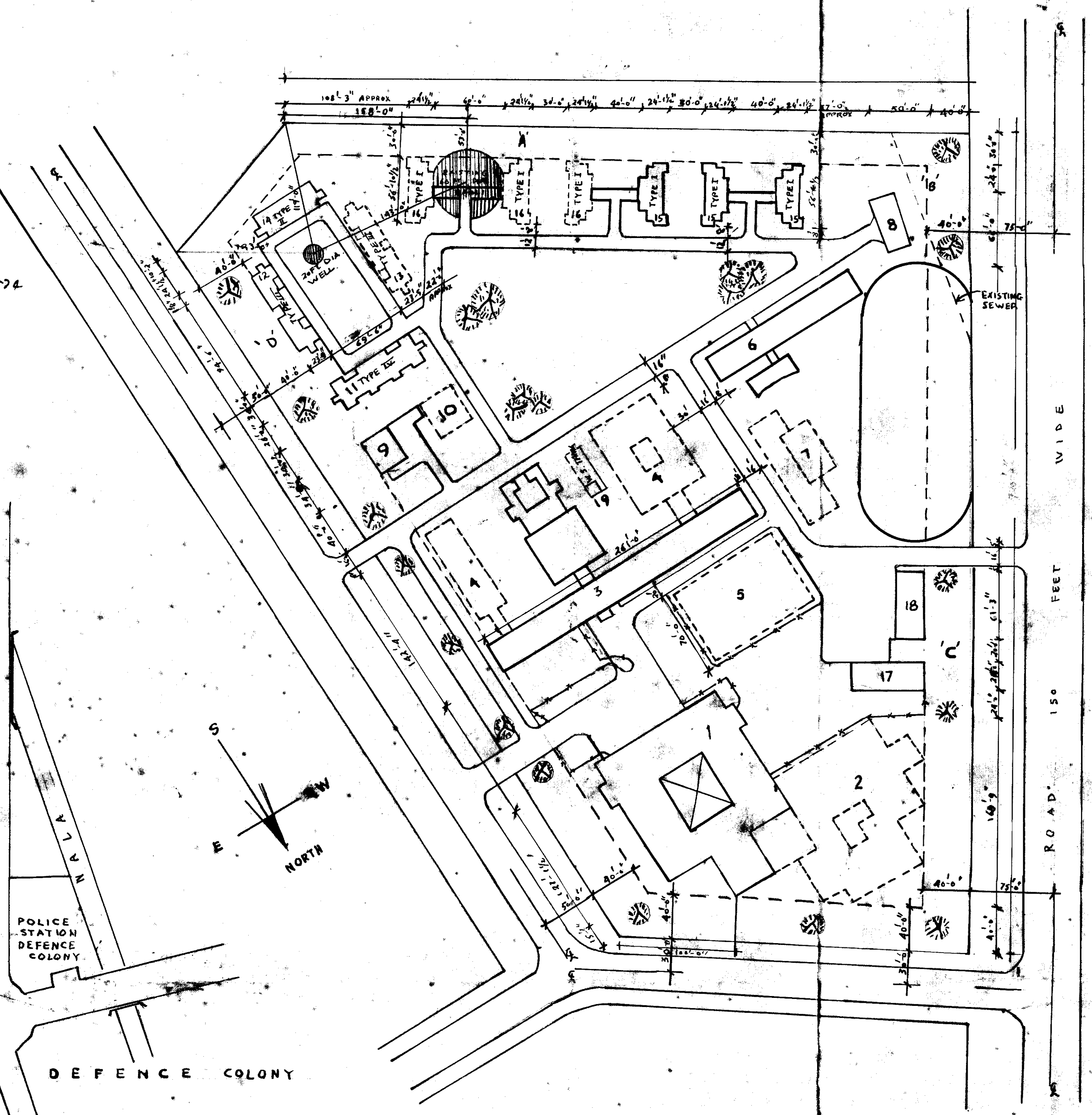

LAY OUT PLAN
SCALE 64 FEET TO AN INCH

AREA CHART				
DESCRIPTION	NUMBER OF FLOORS	NUMBER OF FAMILIES	GROUND FLOOR BUILT UP AREA	TOTAL FLOORS AREA
1 COLLEGE	GROUND AND ONE UPPER		16500.00	33000.00
2 FUTURE EXPANSION OF COLLEGE	GROUND AND ONE UPPER		16500.00	33000.00
3 HOSTEL FOR STUDENTS	GROUND AND SIX UPPER		12407.00	86849.00
4 F. EXPANSION OF HOSTEL	GROUND AND SIX UPPER		9000.00	63000.00
5 AUDITORIUM	GROUND AND HALF UPPER		7300.00	109500.00
6 JUNIOR STAFF HOSTEL	GROUND AND THREE UPPER		3781.00	15124.00
7 F. EXPANSION OF JR. S. HOSTEL	GROUND AND THREE UPPER		5600.00	22400.00
8 CLUB	GROUND FLOOR ONLY		1200.00	1200.00
9 PRINCIPALS FLAT	GROUND AND ONE UPPER		2000.00	2000.00
10 VICE PRINCIPALS FLAT	GROUND AND ONE UPPER		1200.00	1200.00
11 TYPE IV	GROUND AND THREE UPPER		2076.00	8304.00
12 TYPE III	GROUND AND THREE UPPER		1720.00	6680.00
13 FUTURE EXPANSION TYPE III	GROUND AND THREE UPPER		1720.00	6660.00
14 TYPE II	GROUND AND THREE UPPER		1394.00	5576.00
15 TYPE I	GROUND AND THREE UPPER		3126.00	12504.00
16 FUTURE EXPANSION TYPE I	GROUND AND THREE UPPER		3126.00	12504.00
17 ELECTRIC SUB STATION	GROUND FLOOR ONLY		1600.00	1600.00
18 GARRAGES	GROUND FLOOR ONLY		2400.00	2400.00
19 PUMP HOUSE FOR UNDERGROUND WATER STORAGE TANK	GROUND FL. ONLY		150.00	150.00
TOTAL			92800.00	325521.00

PLOT AREA = 9.00 ACRE = 3,92,040 SQ. FT.
PERCENTAGE COVERED AREA = 23.67%
F. A. R. = 83

NOTES:
EXISTING BAOLI SHOULD BE FILLED UP AND LEVELLED. THE WELL AND THE TREE TO BE PROPERLY BUNDED WITH A 2 FEET HIGH WALL ALL ROUND.
PAVING IN FINAL SHAPE SHOWN IN DOTTED LINE WHEN FUTURE EXPANSION OF COLLEGE BUILDING AND AUDITORIUM IS COMPLETED SHOWN THUS.

LAY-OUT PLAN
COLLEGE OF NURSING AND HOSTEL
NEAR KAILASH COLONY NEW DELHI

ARCHITECT	SENIOR ARCHITECT	JOB NO 103	PREPARED BY GOEL S. JINDAL
		DRG. NO 61	SCALE 64 FEET TO AN INCH

ARCHITECTURAL SECTION, D.G.H.S. NEW DELHI

M: 385