

ADDITIONAL COVERAGE FOR CARS AND SCOOTERS
 MARKING CARRIED OVER FROM APPROVED BY D.C.
 S.S. FOR YEAR 1956/57 DATED 31.12.56

LAYOUT PLAN HAS BEEN APPROVED BY THE STANDING COMMITTEE WIDE RESOLUTION NO. 359
 DATED 17TH JULY, 1956 WITH THE FOLLOWING CONDITIONS:

1. BUILDING PLANS FOR THE VARIOUS PROPOSED BLOCKS SHALL BE GOT APPROVED FROM THE BUILDING DEPARTMENT OF THE MUNICIPAL CORPORATION OF DELHI AS PER BUILDING BYE-LAWS AND ZONING REGULATIONS OF THE MASTER PLAN BEFORE TAKING UP THE CONSTRUCTION WORK IN HAND.
2. THE APPLICANT SHALL HAVE TO BEAR THE PROPORTIONATE COST OF THE LAYING OF THE TRUNK AND CENTRALISED SERVICES AND WHEN ASKED FOR BY THE CORPORATION.
3. PORTION OF LAND REQUIRED, 12.45% FOR THE WIDENING AND PROPOSED ALIGNMENT OF THE MATHURA ROAD, SHALL BE LEFT, AS AND WHEN REQUIRED.

[Signature]
 TOWN PLANNER

TOWN PLAN NO. 12-21/28

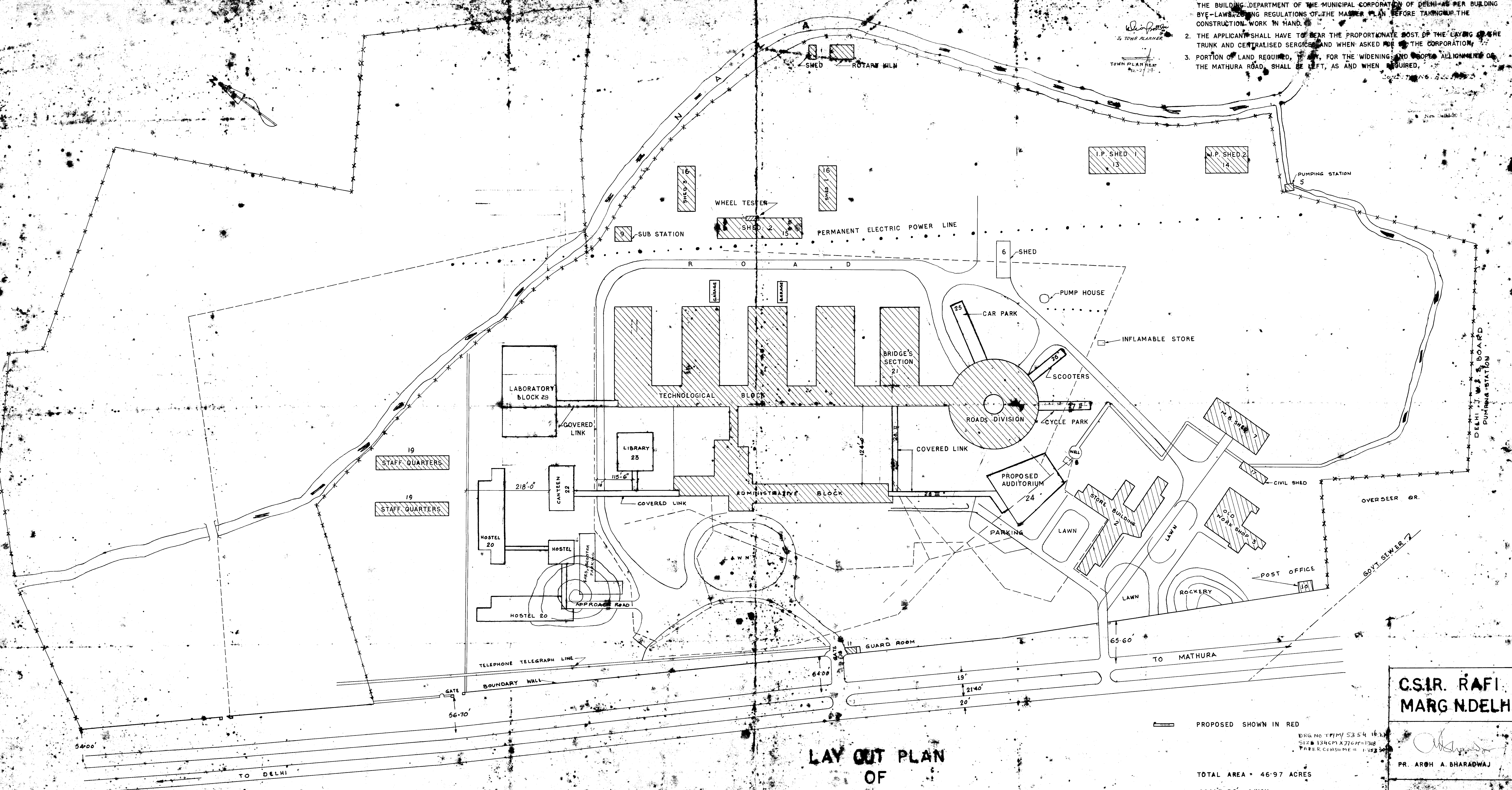

**LAY OUT PLAN
 OF
 CENTRAL ROAD RESEARCH INSTITUTE
 NEW DELHI**

PROPOSED SHOWN IN RED
 TOTAL AREA = 46.97 ACRES
 SCALE 50' = 1 INCH

**C.S.I.R. RAFI
 MARG N.DELHI**

[Signature]
 PR. ARDH A. BHARADWAJ

OWNER
 DIRECTOR
 CENTRAL ROAD RESEARCH INSTITUTE
 CENTRAL DELHI-28

35/5 M