

CONDITIONS FOR APPROVAL AS PER STANDING COMMITTEE'S RES: NO. 24 DATED 1979

1. THE CONDITIONS IMPOSED EARLIER BY THE STANDING COMMITTEE RESOLUTION NO. 17 DATED 1977 SHALL BE OBSERVED.
 2. THE SITE PLANS FOR THE PROPOSED ADDITIONAL PLOTS SHALL HAVE TO BE APPROVED FROM THE STANDING COMMITTEE'S RES: NO. 24 DATED 1979.
 3. THE SITE PLANS FOR THE PROPOSED ADDITIONAL PLOTS SHALL BE IN CONFORMITY WITH THE ZONING BY-LAWS.
 4. THE SITE PLANS SHALL BE IN CONFORMITY WITH THE ZONING BY-LAWS.
 5. THE SITE PLANS SHALL BE IN CONFORMITY WITH THE ZONING BY-LAWS.
 6. THE SITE PLANS SHALL BE IN CONFORMITY WITH THE ZONING BY-LAWS.
 7. THE SITE PLANS SHALL BE IN CONFORMITY WITH THE ZONING BY-LAWS.
 8. THE SITE PLANS SHALL BE IN CONFORMITY WITH THE ZONING BY-LAWS.
 9. THE SITE PLANS SHALL BE IN CONFORMITY WITH THE ZONING BY-LAWS.
 10. THE SITE PLANS SHALL BE IN CONFORMITY WITH THE ZONING BY-LAWS.

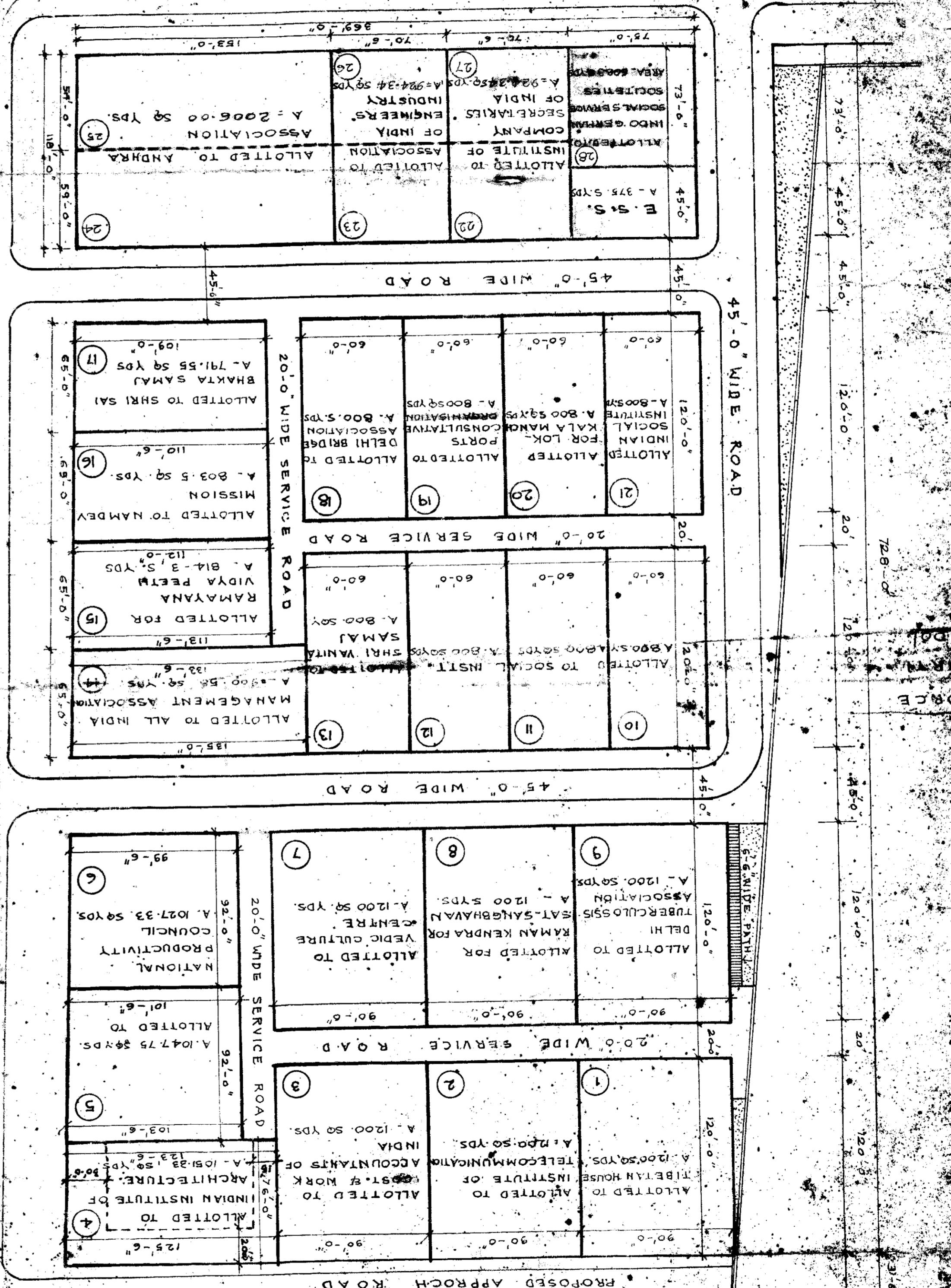

DYAL SINGH COLLEGE

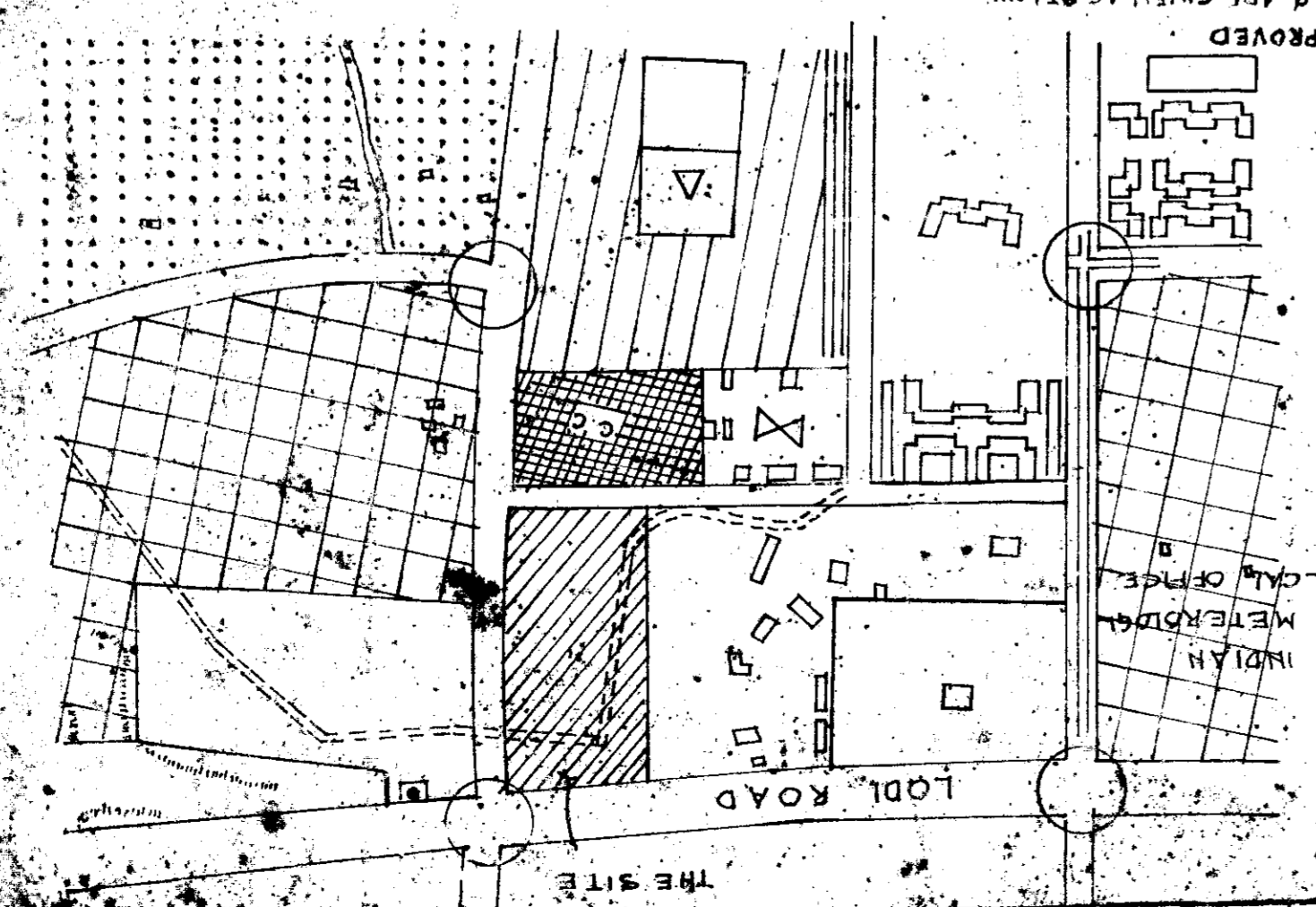

KEY PLAN SHOWING ZONAL PLAN (PART)
 SCALE - 500 = 1"
 SET BACKS MARKED ON PLOT NO. 4 HAS BEEN APPROVED BY L.O.S.C. VIDE ITEM NO. 55/86 DATED 14.2.86 & ARE GIVEN AS BELOW:
 1. FRONT SET BACK FACING LODHI ROAD = 30'-0" (5' OVER HANG)
 2. SIDE SET BACK FACING LODHI ROAD = 20'-0"
 3. REAR SET BACK ADJOINING PROPERTY = 15'-0" (5' OVER HANG)
 4. SIDE SET BACK ADJOINING PLOT NOS. A-104, 105, 106, 107, 108, 109, 110, 111, 112, 113, 114, 115, 116, 117, 118, 119, 120, 121, 122, 123, 124, 125, 126, 127, 128, 129, 130, 131, 132, 133, 134, 135, 136, 137, 138, 139, 140, 141, 142, 143, 144, 145, 146, 147, 148, 149, 150, 151, 152, 153, 154, 155, 156, 157, 158, 159, 160, 161, 162, 163, 164, 165, 166, 167, 168, 169, 170, 171, 172, 173, 174, 175, 176, 177, 178, 179, 180, 181, 182, 183, 184, 185, 186, 187, 188, 189, 190, 191, 192, 193, 194, 195, 196, 197, 198, 199, 200, 201, 202, 203, 204, 205, 206, 207, 208, 209, 210, 211, 212, 213, 214, 215, 216, 217, 218, 219, 220, 221, 222, 223, 224, 225, 226, 227, 228, 229, 230, 231, 232, 233, 234, 235, 236, 237, 238, 239, 240, 241, 242, 243, 244, 245, 246, 247, 248, 249, 250, 251, 252, 253, 254, 255, 256, 257, 258, 259, 260, 261, 262, 263, 264, 265, 266, 267, 268, 269, 270, 271, 272, 273, 274, 275, 276, 277, 278, 279, 280, 281, 282, 283, 284, 285, 286, 287, 288, 289, 290, 291, 292, 293, 294, 295, 296, 297, 298, 299, 300, 301, 302, 303, 304, 305, 306, 307, 308, 309, 310, 311, 312, 313, 314, 315, 316, 317, 318, 319, 320, 321, 322, 323, 324, 325, 326, 327, 328, 329, 330, 331, 332, 333, 334, 335, 336, 337, 338, 339, 340, 341, 342, 343, 344, 345, 346, 347, 348, 349, 350, 351, 352, 353, 354, 355, 356, 357, 358, 359, 360, 361, 362, 363, 364, 365, 366, 367, 368, 369, 370, 371, 372, 373, 374, 375, 376, 377, 378, 379, 380, 381, 382, 383, 384, 385, 386, 387, 388, 389, 390, 391, 392, 393, 394, 395, 396, 397, 398, 399, 400, 401, 402, 403, 404, 405, 406, 407, 408, 409, 410, 411, 412, 413, 414, 415, 416, 417, 418, 419, 420, 421, 422, 423, 424, 425, 426, 427, 428, 429, 430, 431, 432, 433, 434, 435, 436, 437, 438, 439, 440, 441, 442, 443, 444, 445, 446, 447, 448, 449, 450, 451, 452, 453, 454, 455, 456, 457, 458, 459, 460, 461, 462, 463, 464, 465, 466, 467, 468, 469, 470, 471, 472, 473, 474, 475, 476, 477, 478, 479, 480, 481, 482, 483, 484, 485, 486, 487, 488, 489, 490, 491, 492, 493, 494, 495, 496, 497, 498, 499, 500, 501, 502, 503, 504, 505, 506, 507, 508, 509, 510, 511, 512, 513, 514, 515, 516, 517, 518, 519, 520, 521, 522, 523, 524, 525, 526, 527, 528, 529, 530, 531, 532, 533, 534, 535, 536, 537, 538, 539, 540, 541, 542, 543, 544, 545, 546, 547, 548, 549, 550, 551, 552, 553, 554, 555, 556, 557, 558, 559, 560, 561, 562, 563, 564, 565, 566, 567, 568, 569, 570, 571, 572, 573, 574, 575, 576, 577, 578, 579, 580, 581, 582, 583, 584, 585, 586, 587, 588, 589, 590, 591, 592, 593, 594, 595, 596, 597, 598, 599, 600, 601, 602, 603, 604, 605, 606, 607, 608, 609, 610, 611, 612, 613, 614, 615, 616, 617, 618, 619, 620, 621, 622, 623, 624, 625, 626, 627, 628, 629, 630, 631, 632, 633, 634, 635, 636, 637, 638, 639, 640, 641, 642, 643, 644, 645, 646, 647, 648, 649, 650, 651, 652, 653, 654, 655, 656, 657, 658, 659, 660, 661, 662, 663, 664, 665, 666, 667, 668, 669, 670, 671, 672, 673, 674, 675, 676, 677, 678, 679, 680, 681, 682, 683, 684, 685, 686, 687, 688, 689, 690, 691, 692, 693, 694, 695, 696, 697, 698, 699, 700, 701, 702, 703, 704, 705, 706, 707, 708, 709, 710, 711, 712, 713, 714, 715, 716, 717, 718, 719, 720, 721, 722, 723, 724, 725, 726, 727, 728, 729, 730, 731, 732, 733, 734, 735, 736, 737, 738, 739, 740, 741, 742, 743, 744, 745, 746, 747, 748, 749, 750, 751, 752, 753, 754, 755, 756, 757, 758, 759, 760, 761, 762, 763, 764, 765, 766, 767, 768, 769, 770, 771, 772, 773, 774, 775, 776, 777, 778, 779, 780, 781, 782, 783, 784, 785, 786, 787, 788, 789, 790, 791, 792, 793, 794, 795, 796, 797, 798, 799, 800, 801, 802, 803, 804, 805, 806, 807, 808, 809, 810, 811, 812, 813, 814, 815, 816, 817, 818, 819, 820, 821, 822, 823, 824, 825, 826, 827, 828, 829, 830, 831, 832, 833, 834, 835, 836, 837, 838, 839, 840, 841, 842, 843, 844, 845, 846, 847, 848, 849, 850, 851, 852, 853, 854, 855, 856, 857, 858, 859, 860, 861, 862, 863, 864, 865, 866, 867, 868, 869, 870, 871, 872, 873, 874, 875, 876, 877, 878, 879, 880, 881, 882, 883, 884, 885, 886, 887, 888, 889, 890, 891, 892, 893, 894, 895, 896, 897, 898, 899, 900, 901, 902, 903, 904, 905, 906, 907, 908, 909, 910, 911, 912, 913, 914, 915, 916, 917, 918, 919, 920, 921, 922, 923, 924, 925, 926, 927, 928, 929, 930, 931, 932, 933, 934, 935, 936, 937, 938, 939, 940, 941, 942, 943, 944, 945, 946, 947, 948, 949, 950, 951, 952, 953, 954, 955, 956, 957, 958, 959, 960, 961, 962, 963, 964, 965, 966, 967, 968, 969, 970, 971, 972, 973, 974, 975, 976, 977, 978, 979, 980, 981, 982, 983, 984, 985, 986, 987, 988, 989, 990, 991, 992, 993, 994, 995, 996, 997, 998, 999, 1000.

NOTES -
 1. PLOT NO. 7 ALLOTTED TO VEDIC CULTURE CENTRE WIDE L.O.S.C. RES. NO. 17 DATED 1977.
 2. DRG. NO. T.P. 2044/12 WAS APPROVED BY THE M.C.D. WIDE RESOLUTION NO. 74 DATED 07.05.69.
 3. THE SITE PLAN OF INSTUTIONAL AREA AT LODHI ROAD, NEW DELHI APPROVED BY THE STANDING COMMITTEE'S RES. NO. 24 DATED 1979.
 4. ALL THE CONDITIONS IMPOSED EARLIER WHILE APPROVING THE ORIGINAL EAY-OUT PLAN WERE OBSERVED.
 5. AND 641 DATED 11.79 SHALL BE ADHERED TO.

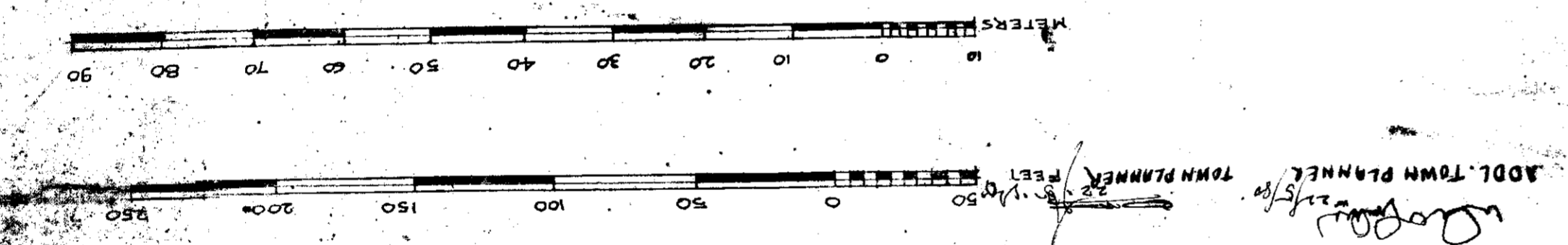

REVISIONS -
 1. T.P. 2044/2 DATED 22.11.69, PROPOSED AS PER LETTER NO. 23/35/CT/1038-99 DATED 4.12.74 FROM EX-ENGINEER CONST. DIV. II, C.M.D. NEW DELHI.
 2. T.P. 2044/3 DATED 20.12.78 PLOT NOS. 22 TO 28 APPROVED.
 3. T.P. 2044/4 DATED 29.3.79 SIDE ROAD TO THE WEST OF PLOT NOS. 1 & 2 DELETED DUE TO NON-AVAILABILITY OF LAND.
 4. T.P. 2044/5 DATED 16.7.79 REVISED AS PER ALLOTMENTS MADE IN PLOTS. DIMENSIONS ETC. SHOWN IN THE DRG. PREPARED BY T.P. 2044/5. THE DRG. HAS BEEN REVISED AS PER DECISIONS TAKEN AT THE MEETING OF L.O.S.C. HELD ON 26.5.79 (ITEM NO. 220/79).
 5. T.P. 2044/6 DATED 22.7.79.
 6. MERGED AS DESIRED BY MUNICIPAL CORPORATION WITH MERGED PLOTS NO. 22 & 27, 23 & 26 AND 24 & 25. HELD ON 21.7.79.
APPROVAL - DRG. APPROVED BY THE STANDING COMMITTEE OF M.C.D. WIDE RESOLUTION NO. 981 DATED 17.1.80. AS ESTIMATED IN LETTER NO. 1148/68/TP/CD/498 DATED 1.2.80.

DRG. NO. T.P. 2044/12
 1. T.P. 2044/12 DATED 22.11.69, PROPOSED AS PER LETTER NO. 23/35/CT/1038-99 DATED 4.12.74 FROM EX-ENGINEER CONST. DIV. II, C.M.D. NEW DELHI.
 2. T.P. 2044/3 DATED 20.12.78 PLOT NOS. 22 TO 28 APPROVED.
 3. T.P. 2044/4 DATED 29.3.79 SIDE ROAD TO THE WEST OF PLOT NOS. 1 & 2 DELETED DUE TO NON-AVAILABILITY OF LAND.
 4. T.P. 2044/5 DATED 16.7.79 REVISED AS PER ALLOTMENTS MADE IN PLOTS. DIMENSIONS ETC. SHOWN IN THE DRG. PREPARED BY T.P. 2044/5. THE DRG. HAS BEEN REVISED AS PER DECISIONS TAKEN AT THE MEETING OF L.O.S.C. HELD ON 26.5.79 (ITEM NO. 220/79).
 5. T.P. 2044/6 DATED 22.7.79.
 6. MERGED AS DESIRED BY MUNICIPAL CORPORATION WITH MERGED PLOTS NO. 22 & 27, 23 & 26 AND 24 & 25. HELD ON 21.7.79.
APPROVAL - DRG. APPROVED BY THE STANDING COMMITTEE OF M.C.D. WIDE RESOLUTION NO. 981 DATED 17.1.80. AS ESTIMATED IN LETTER NO. 1148/68/TP/CD/498 DATED 1.2.80.