

LAYOUT PLAN APPROVED BY THE STANDING COMMITTEE MUNICIPAL CORPORATION OF DELHI VIDE RESOLUTION No 842 DATED 3-9-1970 SUBJECT TO THE CONDITIONS GIVEN BELOW.

*S. D. Verma*  
TOWN PLANNER (L)  
17/3/71  
TOWN PLANNING 10-3-71

CONDITIONS OF APPROVAL.

1. THE BUILDING PLANS FOR THE VARIOUS PROPOSED POULTRY SHEDS, OFFICES AND STORES ETC. SHALL HAVE TO BE GOT APPROVED/REGULARISED FROM THE BLD. DEPT. OF M.C.D AS PER BUILDING BYE-LAWS & ZONING REGULATIONS OF THE MASTER PLAN BEFORE TAKING UP ANY CONSTRUCTION WORK IN HAND.
2. APPLICANT SHALL HAVE TO LEAVE FREE OF COST PORTION OF LAND REQUIRED FROM ITS OWN LAND FOR THE PROPOSED ROAD WIDENING OF THE DELHI GURGOAN ROAD AS PER THE APPROVED ALIGNMENT OF D.D.A.
3. THE EXISTING STRUCTURES COMING IN THE RIGHT OF WAY OF THE ROAD SHALL HAVE TO BE DEMOLISHED.
4. THE EXISTING SHEDS STORES, ETC. PROPOSED TO BE RETAINED SHALL BE MODIFIED AS PER BUILDING BYE LAWS AND SPECIFICATION PRESCRIBED FOR FORM SHEDS.
5. THE SERVICES SHALL BE PROVIDED TO THE ENTIRE SATISFACTION OF THE "COMMISSIONER" AS PER MUNICIPAL STANDARDS
6. THE CONDITIONS/COMMENTS IMPOSED BY THE VARIOUS SERVICES DEPARTMENTS SHALL BE ADHERED TO IN TOTO

DETAIL OF AREAS.

TOTAL AREA OF LAND = 35 BIGHAS & 4 ACRES = 500,940-00 SFT.  
 AREA AFFECTED BY ROAD WIDENING = 472 X 52 = 21,544-00  
 ∴ NET AREA OF LAND = 479,396-00 SFT.  
 PERMISSIBLE COVD AREA = 20% = 95,849-20 SFT.

DETAIL OF COVD AREAS:-  
 EXISTING COVD AREA OF POULTRY SHED TO BE DEMOLISHED & RECONSTRUCTED.  
 SHEDS No = 1, 3, 5, & 7. = 90 (21+30+30+30) OR 90' x 111' 6" = 9,990.00 SFT.  
 " " 2, 4, 6, 8 & 8 = 98 (21+30+30+30) OR 98' x 111' 6" = 10,868.00  
 " " 9, 10, 11. = 96 (14+21+21+38' 3") OR 96' x 73' 9" = 7,117-88  
 " " 12, 13, & 14. = 104 (21+21+32' 3") OR 104' x 66' 9" = 6,942-00  
 TO BE CONVERTED No 15 = 74' 0" x 42' 0" = 3,103-00  
 TOTAL = 38,020-88 SFT.

PROPOSED COVD AREA OF POULTRY SHEDS.  
 SHED 16. = 1 x 40' 0" x 60' 0" = 2,400.00 SFT.  
 " " 17. = 1 x 30' 0" x 70' 0" = 2,100.00  
 " " 18 & 19. = (30+35) x 150' 0" = 9,750.00  
 " " 20. = 1 x 30' 0" x 112' 0" = 3,360.00  
 " " 21 TO 30. = 10 x 30' 0" x 100' 0" = 30,000.00  
 " " 31. = 1 x 10' 0" x 100' 0" = 1,000.00  
 TOTAL = 49,210.00

TOTAL OF (a) + (b) = 38,020.88 + 49,210.00 = 87,230.88 SFT.

PUCKKA STRUCTURE.  
 EXISTING AREA OF STORE = 35' 6" x 18' 6" = 647.50 SFT.  
 OFFICE = 31' 6" x 30' 0" = 945.00 SFT.  
 TOTAL AREA = 1,592.50

AREA OF EXISTING BUILDING AFFECTED BY ROAD WIDENING AND TO BE DEMOLISHED AS WHEN THE LAND IS ACQUIRED FOR ROAD WIDENING.  
 (a) + (b) + (c) + (d) + (e) + (f) + (g) + (h) + (i) + (j) + (k) + (l)  
 (75' 0" x 11' 6") + (19' 3" x 17' 0") + (28' 0" x 41' 0") + (21' 0" x 11' 3") +  
 (26' 0" x 16' 0") + (30' 0" x 24' 0") + (58' 0" x 10' 3") + (60' 0" x 23' 6") +  
 (43' 0" x 10' 0")  
 = 839.50 + 327.50 + 1254.00 + 230.25 + 443.87 + 720.00 + 600.00 +  
 1395.00 + 593.75 = 6,409.62 SFT.  
 SAY = 6,410.00 SFT.

- NOTES
1. THE HEIGHT OF WALLS OF SHEDS TO BE 4' 0" ABOVE WHICH WIRE NETTING MAY BE PROVIDED.
  2. HEIGHT OF SHEDS NOT TO BE EXCEED 15' 0" AND AT EVEN 10' 0"
  3. EXISTING SHEDS SHALL BE DEMOLISHED AND RECONSTRUCTED ONE BY ONE.

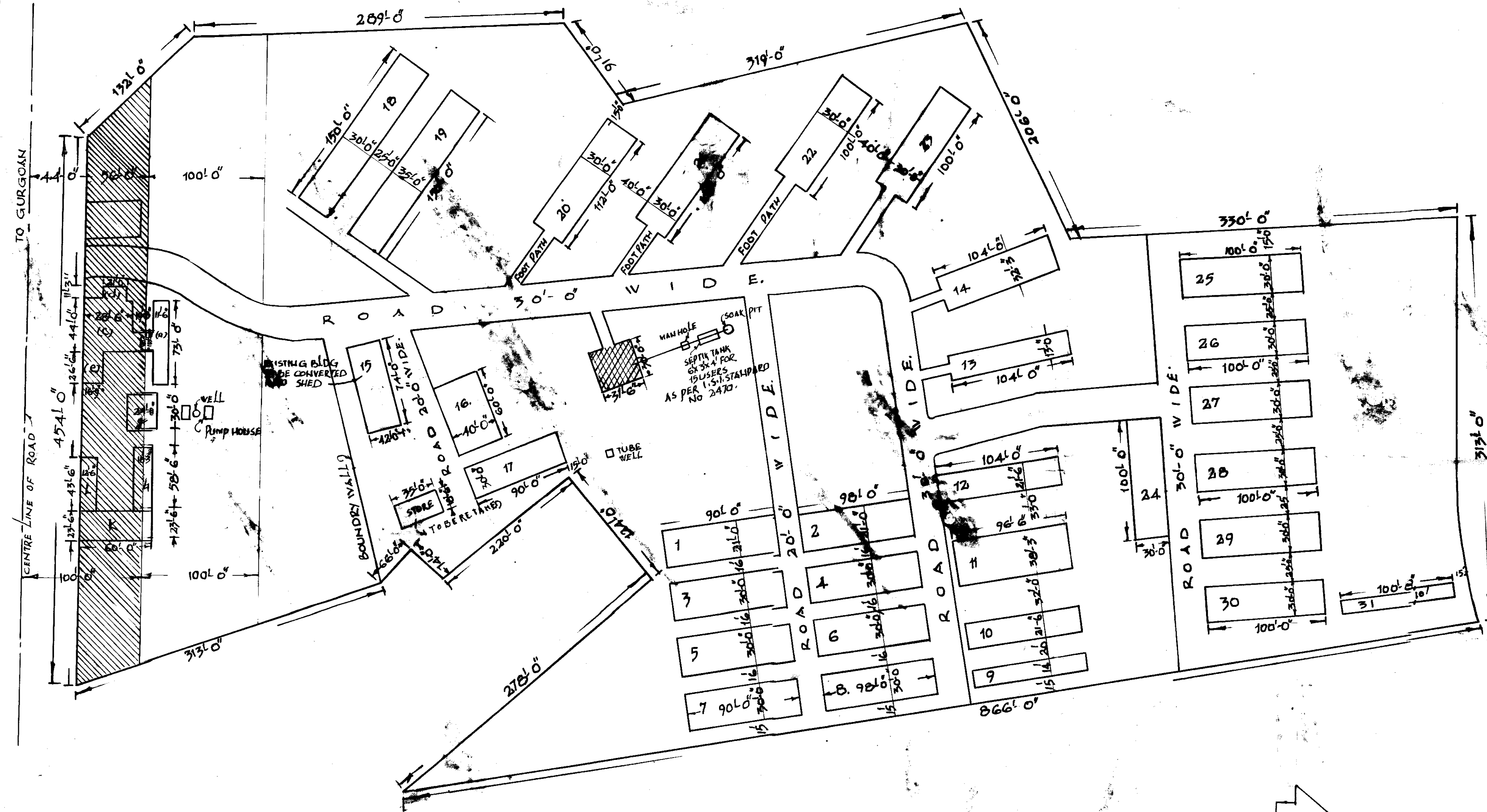

LAYOUT PLAN OF UNIVERSAL POULTRY FARM AT VILLAGE NAGAL DEWAT, GURGOAN ROAD  
 NEW DELHI.

DRG NO: TP/M/ISS/11 18/3/71  
 SIZE: 11.0 X 55.5 X 55.5 CM

*S. D. Verma*  
 APPLICANT.  
 SCALE = 1" = 64' 0"  
 DRAWN BY = S.D. VERMA.

*Anand Swaroop*  
 ANAND SWAROOP GOYAL.  
 Consulting Engineer, Architect, & Plumber  
 B-9 Green Park, New Delhi-16  
 Tele No 968765.