

Block E

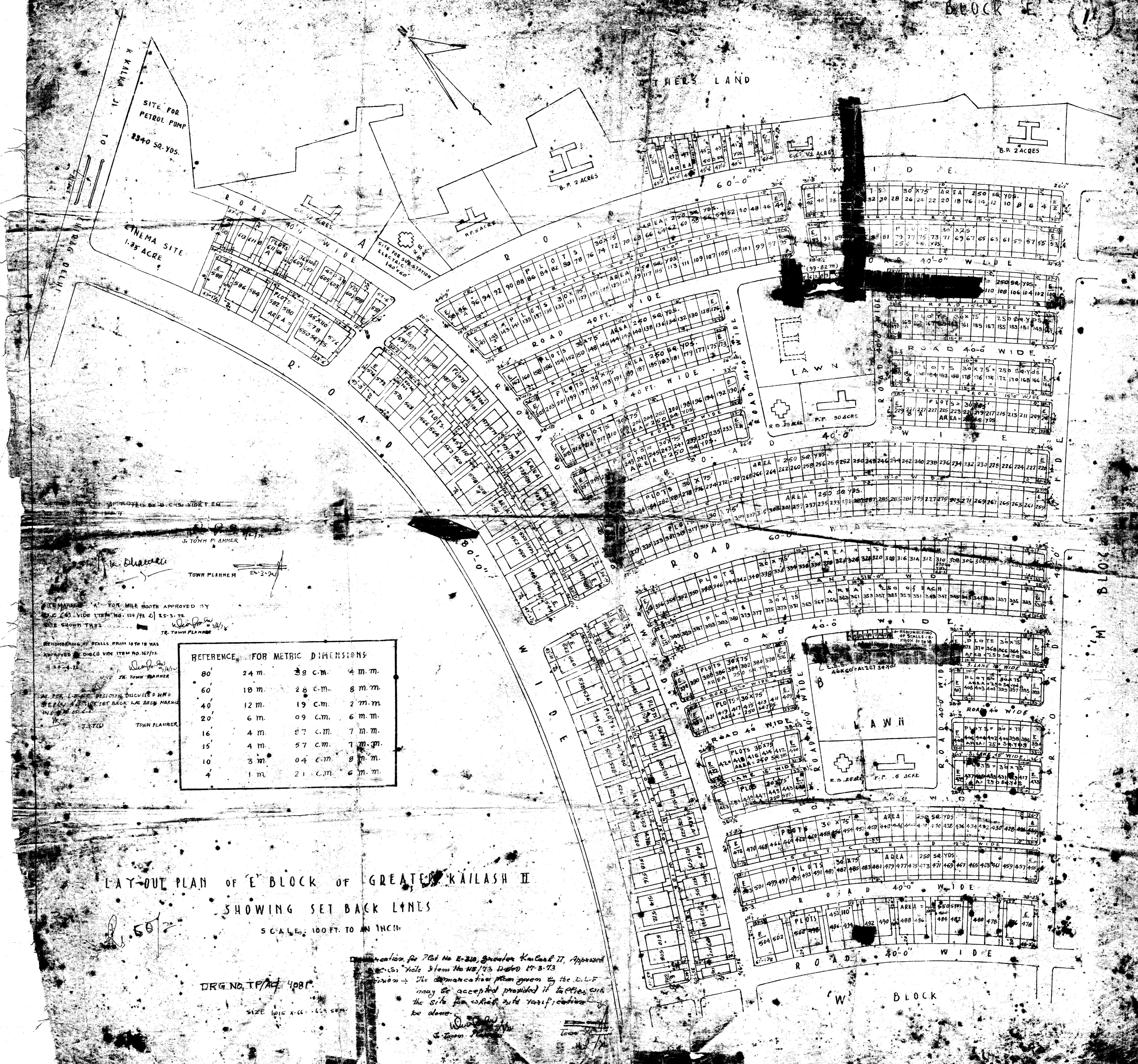

APPROVED BY C.C.S. VIDE ITEM NO. 124/72 D. 25-3-72
 TOWN PLANNER

REVISIONS OF STALLS FROM 1972 WAS APPROVED BY C.C.S. VIDE ITEM NO. 167/72
 TOWN PLANNER

REVISIONS OF STALLS FROM 1972 WAS APPROVED BY C.C.S. VIDE ITEM NO. 167/72
 TOWN PLANNER

REFERENCE FOR METRIC DIMENSIONS			
80	24 m.	39 c.m.	4 m.m.
60	18 m.	26 c.m.	8 m.m.
40	12 m.	19 c.m.	2 m.m.
20	6 m.	09 c.m.	6 m.m.
16	4 m.	07 c.m.	7 m.m.
15	4 m.	57 c.m.	7 m.m.
10	3 m.	04 c.m.	8 m.m.
4	1 m.	21 c.m.	6 m.m.

LAYOUT PLAN OF 'E' BLOCK OF GREATER KAILASH II
 SHOWING SET BACK LINES

SCALE: 100 FT. TO AN INCH

DRG. NO. TP/4/488

Approved for P.B. No. E-210, Greater Kailash II, Approved
 C.C.S. vide Item No. 118/73, Dated 17-3-73
 The demarcation plan given by the D.L.F.
 may be accepted provided it tallies with
 the site plan which site verification
 be done.